

WE OPEN SPACE



# Roto handles

## The catalogue

Handles for windows and balcony doors

Valid from the 1<sup>st</sup> of April 2005



# Roto window handles

## Contents



<b>The Roto company group</b>	<b>1</b>
<b>Information</b>	<b>2</b>
10 year performance warranty	2.1
Surface-finishes: aluminium & brass	2.2
Quality assurance requirements on RAL window handles	2.3
The Secustik® mechanism	2.4
RotoLine 100Nm, Tilt-First function, lockable	2.5
Product liability guidelines	2.6
Installation and care	2.8
<b>T&amp;T window handles without Roto logo</b>	<b>3.1</b>
RotoLine window handles – Standard	3.1.1
RotoLine window handles – Standard 45° click	3.1.3
RotoLine window handles – Secustik®	3.1.5
RotoLine window handles – Lockable 40Nm	3.1.7
RotoLine window handles – Lockable (DIN:100Nm)	3.1.8
RotoLine window handles – Push-button	3.1.10
RotoLine window handles – Service handle (removable)	3.1.11
<b>Door handle sets</b>	<b>3.2</b>
RotoLine door handle sets - escutcheon-cover version	3.2.1
RotoLine door handle sets - escutcheon cover & long-plate version	3.2.3
Copy-template: Request for profile-related (milled) angled long-plates	3.2.7
<b>Cranked handles</b>	<b>3.3</b>
RotoLine cranked handles	3.3.1
<b>Window handle accessories</b>	<b>3.4</b>
Balcony door set accessories, exterior-handles	3.4.1
Replacement / spare keys	3.4.2
Tilt&Turn projecting-limiter with corner-bracket	3.4.2
Spindles	3.4.3
<b>T&amp;T window handles with Roto logo</b>	<b>3.5</b>
DecoLine window handles - Secustik®	3.5.1
DecoLine window handles - Lockable (DIN:100Nm)	3.5.2
RotoLine window handles - Standard	3.5.3
RotoLine window handles - Secustik®, 45° click	3.5.4
RotoLine window handles - Lockable 40Nm	3.5.6
RotoLine window handles - Tilt-First	3.5.7
<b>The hardware product range</b>	<b>3.6</b>
<b>General advice</b>	
<b>Colour chart</b>	<b>(back cover)</b>

### Special designs

Please contact the sales representative responsible for you for requests concerning special designs.



# The Roto company group



Production-plant in Leinfelden-Echterdingen, Germany - Roto group headquarters.

## Production companies

### Roto Frank AG

Leinfelden-Echterdingen

Architectural hardware · Building elements

Roto Frank  
Bauelemente GmbH  
Bad Mergentheim

Replacement roof-windows · Roof windows  
Flashings · Insulation glass · Solar / Thermal

Columbus Treppen GmbH  
Neusaess

Spiral staircases · Retractable scissors loft ladders ·  
Closed string staircases

Roto Frank  
Eisenwarenfabrik AG  
Kalsdorf (A)

Architectural hardware · Locks

Roto Frank AG o.o.o.  
Moscow (RUS)

Architectural hardware

Elzett Sopron Kft.  
Sopron (H)

Surface finishing technology

Roto Elzett Certa Kft.  
Lövö (H)

Architectural hardware · Locks

Roto Frank Sp z o o  
Lubartow (PL)

Roof-windows

Roto Lož d.o.o.  
Stari trg pri Ložu (SLO)

Architectural hardware

Roto Frank of America Inc.  
Chester, Ct. (USA)

Architectural hardware ·  
Roof-windows

Roto Frank Co. Ltd.  
Beijing (RC)

Architectural hardware



Entrance area of the corporate headquarters in Leinfelden-Echterdingen, Germany.

## Sales subsidiaries / partners

<b>S.A. Roto Frank N.V.</b> Nivelles (B)	<b>SARI S.r.l.</b> Meolo (I)	<b>Roto Frank</b> Warsaw (PL)	<b>Roto Frank S.A.</b> Sant Celoni (E)
<b>Kovinoplastika d.o.o.</b> Sarajevo (BIH)	<b>Tekno System s.r.l.</b> Apricena (I)	<b>Roto Romania SRL</b> Bucharest (RO)	<b>Roto Nové Město</b> Nové Město na Moravě (CZ)
<b>Roto Frank Ehitusrutised</b> Tallinn (EST)	<b>Kovinoplastika d.o.o.</b> Zagreb (HR)	<b>Roto Frank AG</b> Moscow (RUS)	<b>Roto Frank Ltd. Şti.</b> Istanbul (TR)
<b>Roto Georgia presentation</b> Tbilissi (GE)	<b>Roto Frank Okucia</b> Budowlane Jurmala (LV)	<b>Roto Frank AG</b> Dietikon (CH)	<b>Roto Frank</b> Kiev (UA)
<b>Eurotechnica</b> Thessalonica (GR)	<b>Roto Frank Atstovybe</b> Lietuvoje Vilnius (LT)	<b>Lož Beograd d.o.o.</b> Belgrade-Banovo Brdo (YU)	<b>Roto Frank</b> Minsk (BY)
<b>Roto Frank Ltd.</b> Rugby (GB)	<b>Roto Frank B.V.</b> Houten (NL)	<b>Kovinoplastika Lož d.d.</b> Stari trg pri Ložu (SLO)	<b>Roto Elzett</b> Vasalatkereskedelmi Kft. Lövö (H)
<b>Roto Frank Ferrures</b> Saint Avold			





## The Roto performance warranty

A high-quality Roto product always means keeping a promise of high quality to all our customers. The best proof of this is the 10 year performance warranty on all Roto door and window handles (provided the respective installation and maintenance directives have been adhered to; please refer to „Product liability guidelines“ on pages 2.6 and 2.7)

The long-term perfect function of Roto door and window handles is tested in numerous tests. Depending on the requirements; durability tests and static endurance tests are carried out, that realistically simulate the demanding “everyday life” of door and window handles and clearly exceed the test requirements in accordance with DIN EN 1906 and/or RAL-RG 607/9.

The handles are tested independently during the test cycles in the durability tests in accordance with DIN EN 1906 and RAL-RG 607/9. The operation of door and window handles is tested (in accordance with the appropriate operation cycle quantity) under realistic conditions while fixed to product test specimens (door or window). This means that apart from the actual operational function, also the durable connection between the handle and the product test specimen is tested. While testing, the number of operation cycles is far higher than the two aforementioned technical standards - after all: it is a Roto handle!

With the 10 year performance warranty, Roto surpasses the obligatory 2 year warranty enforced in the German Civil Code („BGB“= Bürgerliches Gesetz Buch) and the 5 year warranty period stated in „VOB“ for project business. (VOB = VerdingungsOrdnung für Bauleistungen = Contract procedure for building works).

### Warranty service:

Beyond the vendors legal quality warranty, we as manufacturers warrant perfect durability of properly used Roto door and window handles under the following conditions. The warranty covers the function of Roto door and window handles and covers all defects that are evident as fabrication or material defects.

### The performance warranty covers the following features:

- Transmission of the rotational motion for the door lock or for the Tilt&Turn window hardware
- Blocking mechanism (on window handles with special functions: lockable, automatic locking & Secustik®)

### Warranty exemption:

All interchangeable individual components, for example screws, connection pins (spindle) etc. are exempt from this warranty. Furthermore, no liability is accepted for damages that have arisen from:

- unsuitable and inappropriate application,
- defective and careless treatment,
- nonobservance of installation and maintenance instructions, modifications and self repairs,
- chemical and physical damage on the material surface-finish arising from improper use; for example damage caused by sharp objects,
- doors or windows not in perfect working order and/or hardware components (e.g. locks, hinges etc.)

### Warranty conditions:

Our warranty consists of either carrying out repairs on the product free of charge for the firsthand end user within the warranty period or if we choose to do so, supply a free of charge replacement delivery. The warranty-recipients incurred costs, expenses, postage and suchlike shall not be reimbursed. The warranty claim exists only upon presentation of the product as well as the receipt, and the maximum warranty claim amount is the stated purchase price.

### Warranty period:

The warranty period is 10 years and begins on the day of purchase by the firsthand end user. In case of complaints, please contact the seller or the manufacturer directly, presenting the product itself and proof of purchase.

# Roto window handles

## Surface-finishes: aluminium & brass

### Aluminium

Roto aluminium window handles are made of high-quality, corrosion-resistant alloys. The surface-finishing of these well-proven Roto handles takes place during the anodising or powder coating process. A protective surface layer (oxide layer) is created from the product during the anodising process by means of a well-directed and controlled artificial oxidation process using electricity and sulphuric acid (consolidation of the material with oxygen). This protects the products against external influences such as hand sweat, humidity, and mild mechanical wear. Damaging the surface-finish, for example from rings or keys, causes no corrosion.

During the powder coating process, paint powder is applied onto the aluminium surface with the help of an electrostatic process. Afterwards the baked enamel finish is carried out at a temperature of between 150° and 220° C, whereby the paint particles melt to a coating film during the cross-linking reaction.

Health hazards from aluminium hardware are not known. Aluminium material does not require particular care as the created oxide layer protects the aluminium. Soiling can be removed with a soft damp cloth.

### Brass

Roto brass window handles are produced from the best brass alloys. The surface-finish is protected by transparent stove enamel with very good adhesive strength and high solvent and chemical resistance. If the protective layer of the baked enamel finish is damaged by means of mechanical action (e.g. a key), this leads to corrosion (turns brown). Brass hardware does not require any particular care. Soiling can be removed with a soft damp cloth. Do not use abrasive cleaning detergents.



# Quality assurance requirements on RAL window handles



These quality assurance requirements are an excerpt from the March 1989 edition of the "Quality assurance and testing-regulations RAL-RG 607/9" They are valid for window handles with the following specified dimensions and specifications:

- The centre distance of the lugs is  $43 \pm 0.2\text{mm}$
- The surface-finish is free of scratches, stains, cracks, oxide flaws and shrinkage cavities. There are no sharp edges that can lead to injuries during operation. On aluminium hardware, the anodised coating is at least  $8 \mu$ .
- The mounted spindle does not loosen unintentionally and has a galvanisation thickness of at least  $6\mu$  or comparable surface protection.
- The tested window handle shall withstand the demands of an endurance test of 10,000 operational cycles at a turn-resistance of 3 Nm. After the endurance test, a measured difference of 0.8 Nm between the disengaging moment of force and the no-load operation moment is confirmed; the relevant no-load operation moment in this case shall be a maximum of 0.8 Nm. The disengaging moment of force when brand new is less than 3.5Nm.
- After the endurance test, the upward play measured 100mm from the centre of the spindle to the end of the handle shall be no more than  $\pm 2\text{mm}$ .
- Tensile test: The window handle withstands a 2kN tensile load on the handle (in the centre of the spindle), as well as a 1.2 kN tensile load on the handle measured 50mm from the spindle centre.
- Torsional test: The window handle bears a load of 0.2 kN, 85mm from the spindle centre. In this case, the handle is less than 2mm permanently deformed.

## The original is RAL tested!

RotoLine window handles and DecoLine window handles meet the quality assurance and testing-regulations in accordance with RAL-RG 607/9 and with that, give you the security of having window handles tested by self- and external monitoring processes.

## Window handle tests

For window handles, the RAL-RG 607/9 stipulates 10,000 Tilt&Turn test cycles for the durability test. Also here, Roto goes a step further: Within the framework of the warranty performance test, Roto window handles, undergo 15,000 Tilt&Turn operation cycles on the window (1 Tilt&Turn operation cycle = x 1 opening and closing of the window, plus x 1 tilting and closing of the window), this corresponds to 10 years x 4 opening and closing, plus x 4 tilting and closing of the window per day. After the operation (switch) endurance test, the window handles are also tested for strength. In addition to withstanding the test, they shall continue to function perfectly.

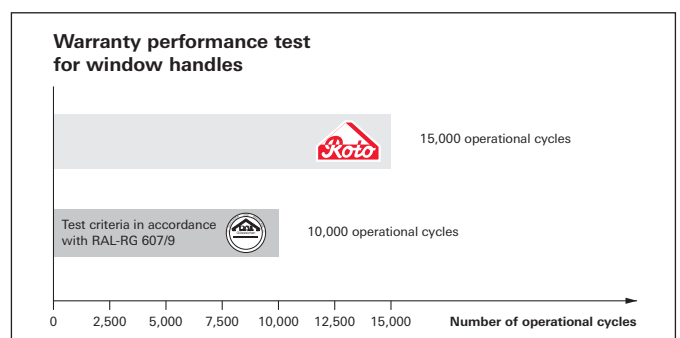

# Roto window handles

## The Secustik® mechanism

Secustik® window handles are equipped with a patented blocking mechanism as part of the integrated basic security. This prevents manipulating the window hardware from the outside. A swivel clutch between the handle and spindle acts in this case as “a mechanical diode”. It permits normal operation of the window handle from the inside, blocks the handle however if somebody attempts to manipulate the window handle via the hardware from the outside. With this, the handles meet the requirements in accordance with A-J.H. RAL-RG 607/13 (Anti-Jemmy Hardware).

During the Secustik® handles 180° operation from the locking mode to tilting mode, the self-locking blocking mechanism engages into the different handle positions with a discreet click. This click emphasises the outstanding plus in security.

**This is how the Secustik® technology works:**

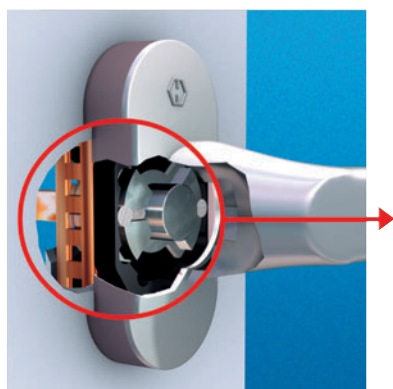

Secustik® window handles patented blocking mechanism.

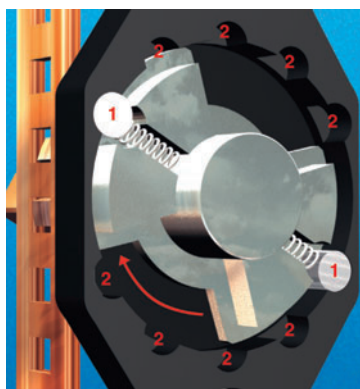

When turning the window handle, the spring-loaded safety pins ① engage into special recesses in the housing ② with a distinct click.

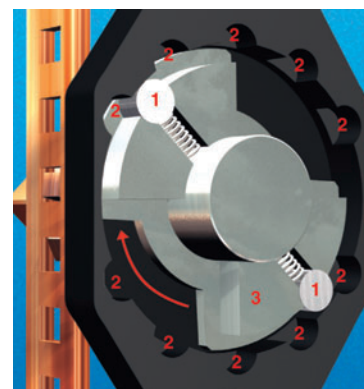

During the turn movement, the safety pins ① are moved along the swivel clutch ③ into further recesses ② where they again audibly engage.

**Secustik® technology effectively prevents attempted break-ins**

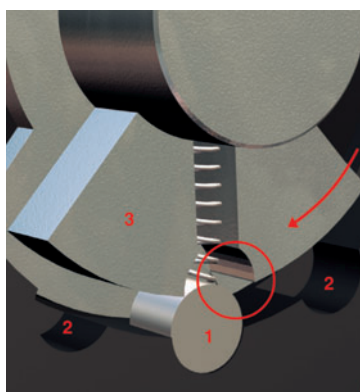

In the case of an attempted break-in, the safety pins ① are pushed through a second swivel clutch ③ into the housing recesses ②.

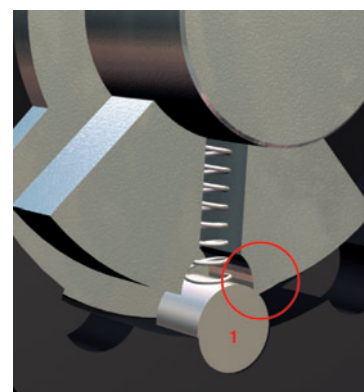

In this position, the safety pins ① effectively prevent turning the window handle from the outside. The window handle blocks and prevents the attempted break-in.

Secustik® is a registered trademark of the HOPPE Holding Corp.

## RotoLine 100Nm – the new convenient security grade

- Meets the requirements of the European standard DIN V ENV 1627-1630 and can therefore be marketed in all EU member states
- Corresponds with DIN 18104-1 for burglar-inhibiting retrofit products; creating additional sales opportunities in the renovation sector
- Attractive cost-benefit ratio
- Very convenient due to the large turn-key and easy to use push-cylinder
- Lockable window handle tested to a torque of 100Nm: high mechanical security that provides good burglary protection and is an effective child safety lock
- Meets the requirements in all burglary-resistance grades combined with the appropriate window
- Locks the closed/tilted window rapidly and simply "at the push of a button"

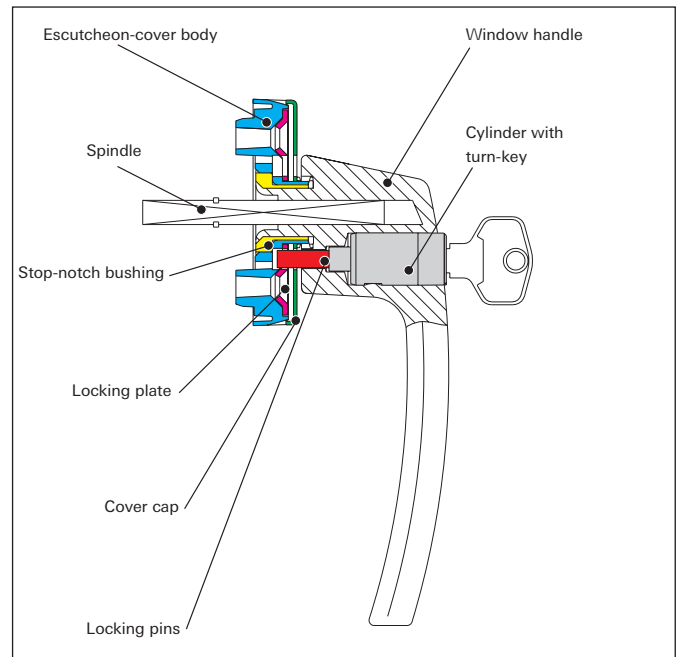

## Lockable RotoLine Tilt-First handle

The RotoLine Tilt-First handle (Tilt before Turn) is designed for the Locking-, Tilting-, and Turn mode. The handle is equipped with a free-running mechanism between the locked position and the tilted position (unlocking the cylinder is not necessary) in order to enable ventilating. A blocking mechanism is located at the limit-stop of the 90° tilt position. Continuing to move the handle into the 180° turn position is only possible after unlocking the cylinder.

Furthermore, the handle can be locked in the 0° locked position, thus providing an additional burglar-inhibiting security function.

In addition, this innovative handle is equipped with a unique automatic locking function that blocks the opening operation in the 180° turn mode, without locking the cylinder.

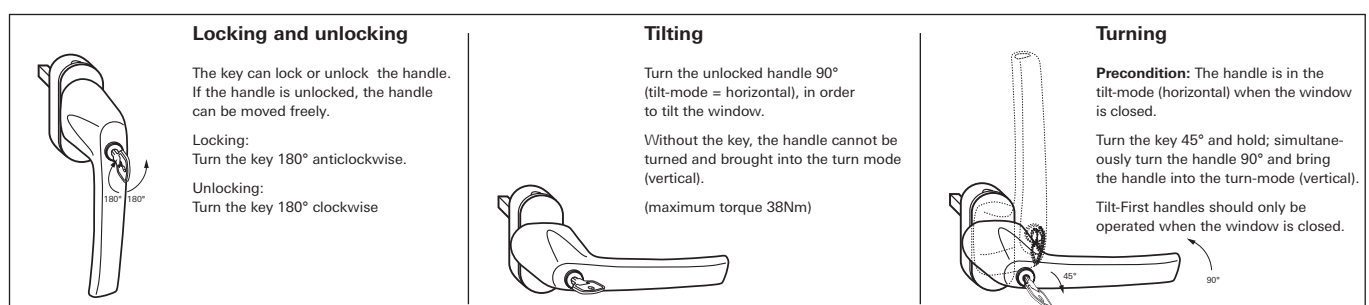

# Roto window handles

## Product liability guidelines

### For hardware / operation mechanisms for doors and windows, (e.g. window handles and door handle sets)

Due to the new product liability law, the manufacturer should define the product liability in a performance-oriented manner (instructions and duty to warn).

For this reason, Roto pays particular attention to the following information concerning Roto operation mechanisms (handles):

1. Product information and stipulated application
2. Misuse (inappropriate or adverse use)
3. Product performance
4. Product maintenance
5. Obligation to issue information and instructions
6. Application of related hardware

#### 1. Product information and stipulated application

Roto operation mechanisms (handles) are products with whose help, opening and closing movements and/or blocking operations on doors, balcony doors and windows in building constructions can be carried out.

Their application usually transpires in connection with hardware systems such as locks, cylinders, or Tilt&Turn hardware (Roto NT).

Mandatory legal regulations must be absolutely adhered to.

It is imperative to use the supplied fixing materials and mount them in accordance with the installation instructions.

This is valid for fixing materials:

- from Roto.
- for all fixing materials and/or the regulations appertaining to the hardware product (window handles: screws from the Tilt&Turn hardware manufacturer).

Products used in an aggressive, corrosive environment are considered "special hardware"; their application (use)

should only take place upon previous consultation with Roto.

#### 2. Misuse (inappropriate or regulation-adverse use)

Misuse – therefore not the specified product utilisation – of hardware systems for doors and windows occurs in particular:

- If operation takes place with auxiliary tools (e.g. pliers or attached pipes), or the exertion of additional loads (retaining and bracing forces) are present (for example; placing an object under a door handle, in order to block the door),
- If forces exceeding the normal manual force on the handle are present (for example; to try and eliminate blocking the Tilt&Turn hardware with increased force or the use of door handles as a retaining mechanism (for example with children),
- If external and/or non specified objects are used (for example; pins/spindles from other manufacturers or the combination of non-Roto components with Roto components),
- If interference and/or an attack takes place that influences the function (e.g.; break-in or break-out tests with auxiliary tools on lockable window handles),
- If the surface is damaged with sharp objects,
- If because of the use of a non-Roto or non-specified object in the hardware system or striker-plate prevents perfect operation,
- If a burglary attempt is carried out on the hardware system or striker, which results in a modification of the construction, or affects its function.

#### 3. Product performance

The DIN (German-Industrial-Norm) standards 18255, 18257, as well as 18273 are the decisive trend setting hardware system standards for doors, and RAL-RG 607/9 for window hardware systems.

The contents of these standards also apply in the general sense to other hardware.

The RAL regulations, as well as the relevant institute regulations (e.g. the institute of window technology in Rosenheim) apply to window handles.

Requirements that exceed those set in the documentation are to be individually agreed upon with Roto.

The duration of the suitability of use for products is particularly dependent on;

- Operational frequency,
- Operational manner,
- Environment and care.

The replacement of a hardware system is then necessary, if in spite of maintenance and care, the function is no longer guaranteed, and/or the surface poses risk of injury.

#### 4. Product maintenance

The correct performance-related positioning of the hardware system and the use of correct fixing materials is to be adhered to!

All movable components must be serviced at least once a year.

This applies in particular to door-handle pin connections as well as cylinders for lockable window handles. Particular attention must be paid to cylinders; non-resinifying oils are to be used (graphite is the wiser choice).



Hardware systems are to be treated with cleaning agents recommended by Roto according to their use.

In principle, these may not be treated with strong acid and alkaline solutions. In any case, soiling with mortar and similar materials is always to be avoided. Only detergents that do not contain corrosive components should be used.

## **5. Obligation to issue information and instructions**

The following documentation is available to authorised dealers, planning engineers, architects, advising institutions, fabricators, builders, and users:

- Catalogues and brochures,
- Invitations to tender text,
- Purchasing information,
- Offer documentation,
- DIN standards: 18255, 18257, 18273 as well as the applicable standards (Beuth Publishers Ltd, 10785 Berlin), operation, care and installation instructions.

In addition, Roto is available for consultation if required.

Upon selecting Roto hardware systems, as well as installation, operation and care:

- Architects, planning engineers and advising institutions are obliged to request and comply with all necessary manufacturers' product information.
- Specialised dealers are obliged to observe the product information and advice in the documentation, and in particular to request and pass on all the necessary instructions to the fabricator.
- Fabricators are obliged to observe the product information and in particular to request operating & care instructions from Roto, and to pass this on to the clients and end users.

## **6. Application of related hardware**

The possible variations within the individual hardware system, as well as accessories, are to be treated according to the corresponding valid features of product performance, product maintenance, information and instruction obligations, product information, specified use/application, and misuse.

# Roto window handles

## Installation and care

### Installation instructions

Install on the window sash in the turn-mode.

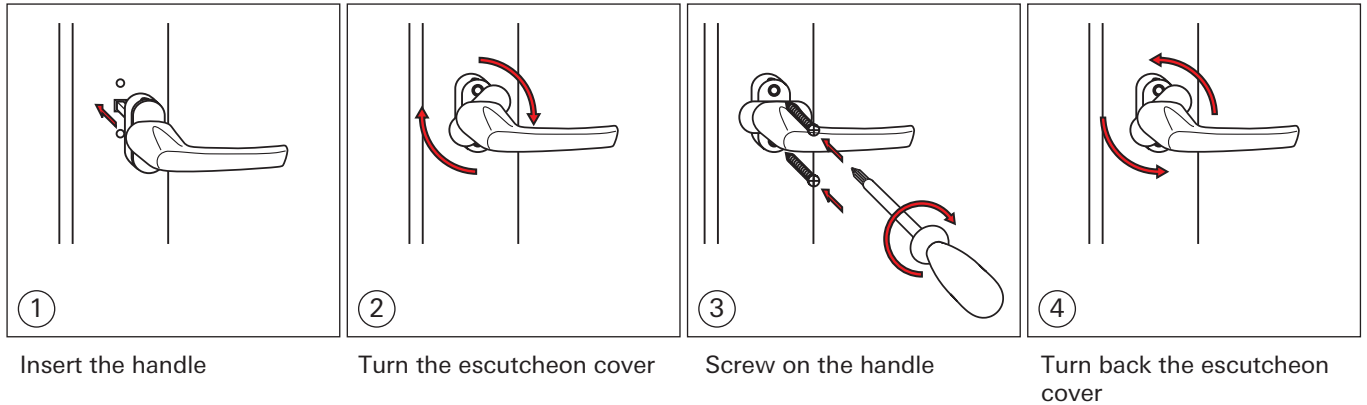

To dismantle an old handle, apply the instructions in the reverse order.

### Cleaning and care

The following is suitable to clean handles:

- Timber or PVC spatula.
- Lukewarm water with standard, commercially available soap-based household cleaning agents.
- Cleaning agents that are specially produced for (anodised) aluminium components.

More information concerning suitable cleaning agents can be provided by your Roto subsidiary.

You **may not** clean the handles with the following:

- Sharp-edged tools such as knives, metal spatulas, steel wool, the abrasive side of household sponges and so forth. These tools cause surface-finish damage.
- Aggressive cleaning solutions or solvents such as nitro-cellulose thinners, nail-varnish remover, scouring agent and so forth. These agents also cause surface-finish damage.

# Roto window handles

## RotoLine window handles without Roto logo – Standard

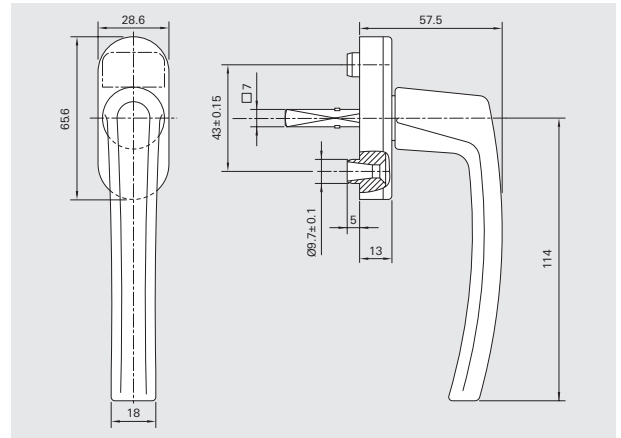

### RotoLine window handle, 30mm spindle length, with Ø10mm lugs – without Roto logo

Roto colour no.	Handle and escutcheon cover colour	Base plate colour	Material number	Supply-Service Grade
R 01.1	silver, anodised	silver-grey	<b>228 079</b>	1
R 01.2	champagne, anodised	beige	<b>228 081</b>	2
R 01.3	titanium matt, anodised	grey	<b>227 982</b>	1
R 03.1	brass matt, anodised	brass-colour	<b>228 083</b>	2
R 04.1	grey-brown; RAL 8019	brown	<b>227 986</b>	2
R 05.3	medium bronze, anodised	medium-bronze	<b>228 086</b>	2
R 05.5	bronze, anodised	bronze	<b>228 088</b>	2
R 07.2	traffic-white; RAL 9016	white	<b>227 990</b>	1

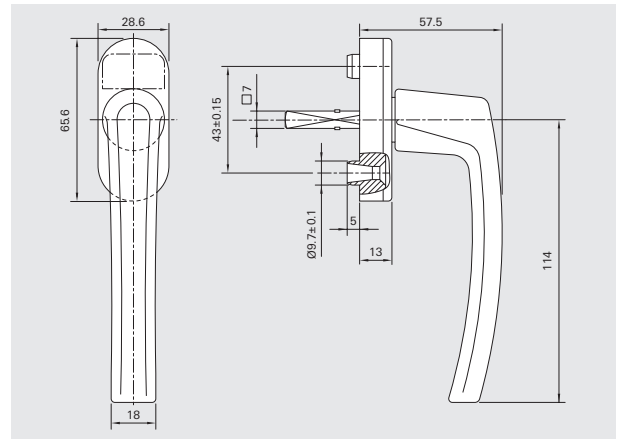

### RotoLine window handle, 35mm spindle length, with Ø10mm lugs – without Roto logo

Roto colour no.	Handle and escutcheon cover colour	Base plate colour	Material number	Supply-Service Grade
R 01.1	silver, anodised	silver-grey	<b>228 090</b>	1
R 01.2	champagne, anodised	beige	<b>228 092</b>	2
R 01.3	titanium matt, anodised	grey	<b>227 996</b>	1
R 03.1	brass matt, anodised	brass-colour	<b>228 094</b>	2
R 04.1	grey-brown; RAL 8019	brown	<b>228 000</b>	2
R 05.3	medium bronze, anodised	medium-bronze	<b>228 096</b>	2
R 05.5	bronze, anodised	bronze	<b>228 098</b>	2
R 07.2	traffic-white; RAL 9016	white	<b>228 004</b>	1

# Roto window handles

## RotoLine window handles without Roto logo – Standard

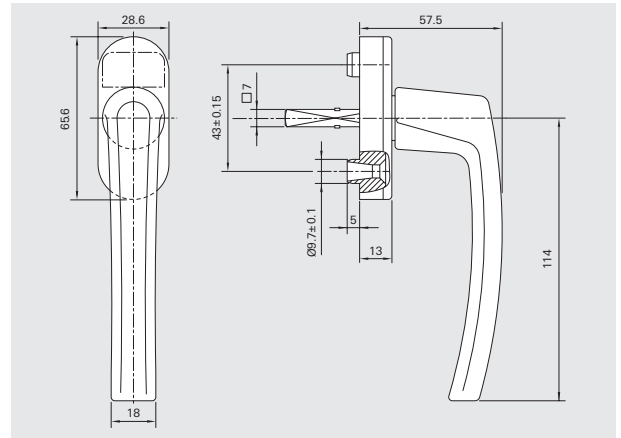

### RotoLine window handle, 40mm spindle length, with Ø10mm lugs – without Roto logo

Roto colour no.	Handle and escutcheon cover colour	Base plate colour	Material number	Supply-Service Grade
R 01.1	silver, anodised	silver-grey	<b>348 375</b>	1
R 01.3	titanium matt, anodised	grey	<b>262 935</b>	1
R 03.1	brass matt, anodised	brass-colour	<b>349 653</b>	2
R 04.1	grey-brown; RAL 8019	brown	<b>349 654</b>	2
R 05.3	medium bronze, anodised	medium-bronze	<b>364 502</b>	2
R 05.5	bronze, anodised	bronze	<b>364 503</b>	2
R 07.2	traffic-white; RAL 9016	white	<b>263 658</b>	1



# RotoLine window handles without Roto logo – Standard & with 45° click

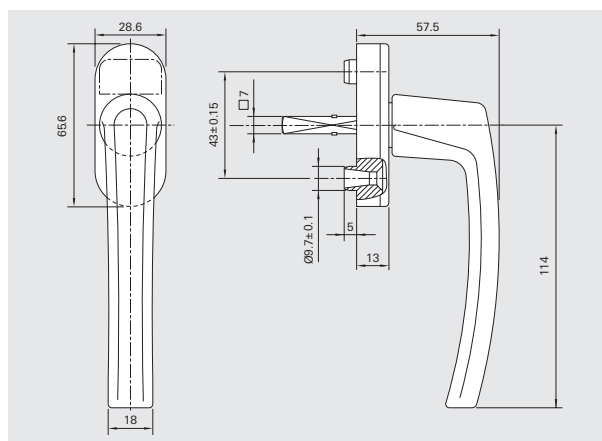

## RotoLine window handle, 45° click, 32mm spindle length, with Ø10mm lugs – without Roto logo

Roto colour no.	Handle and escutcheon cover colour	Base plate colour	Material number	Supply-Service Grade
R 01.1	silver, anodised	silver-grey	<b>228 145</b>	3
R 01.3	titanium matt, anodised	grey	<b>228 061</b>	3
R 03.1	brass matt, anodised	brass-colour	<b>228 147</b>	3
R 04.1	grey-brown; RAL 8019	brown	<b>228 064</b>	3
R 07.2	traffic-white; RAL 9016	white	<b>228 065</b>	3

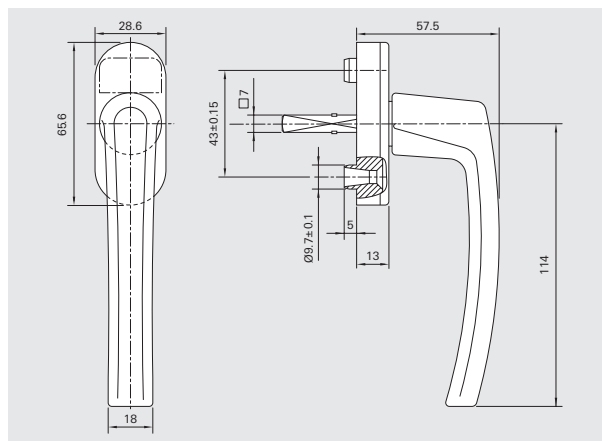

## RotoLine window handle, 45° click, 37mm spindle length, with Ø10mm lugs – without Roto logo

Roto colour no.	Handle and escutcheon cover colour	Base plate colour	Material number	Supply-Service Grade
R 01.1	silver, anodised	silver-grey	<b>373 935</b>	3
R 01.3	titanium matt, anodised	grey	<b>373 936</b>	3
R 03.1	brass matt, anodised	brass-colour	<b>373 938</b>	3
R 04.1	grey-brown; RAL 8019	brown	<b>374 829</b>	3
R 07.2	traffic-white; RAL 9016	white	<b>373 942</b>	3
R 07.3	cream-white	white	<b>373 944</b>	3

# Roto window handles

## RotoLine window handles without Roto logo – Standard & with 45° click

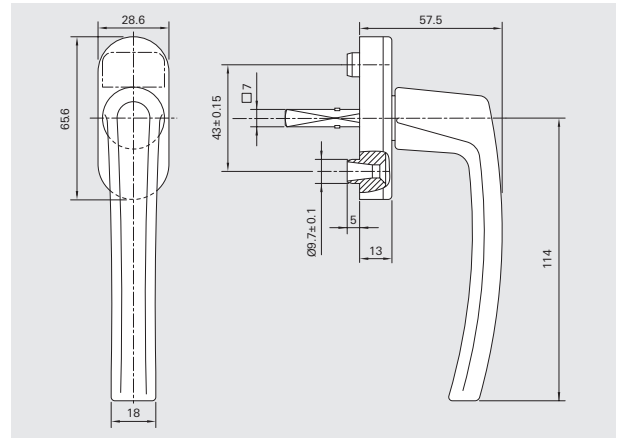

### RotoLine window handle, 45° click, 40mm spindle length, with Ø10mm lugs – without Roto logo

Roto colour no.	Handle and escutcheon cover colour	Base plate colour	Material number	Supply-Service Grade
R 01.1	silver, anodised	silver-grey	<b>373 945</b>	3
R 01.3	titanium matt, anodised	grey	<b>373 946</b>	3
R 03.1	brass matt, anodised	brass-colour	<b>373 947</b>	3
R 04.1	grey-brown; RAL 8019	brown	<b>373 948</b>	3
R 07.2	traffic-white; RAL 9016	white	<b>373 949</b>	3
R 07.3	cream-white	white	<b>373 950</b>	3

# RotoLine window handles without Roto logo – Secustik®

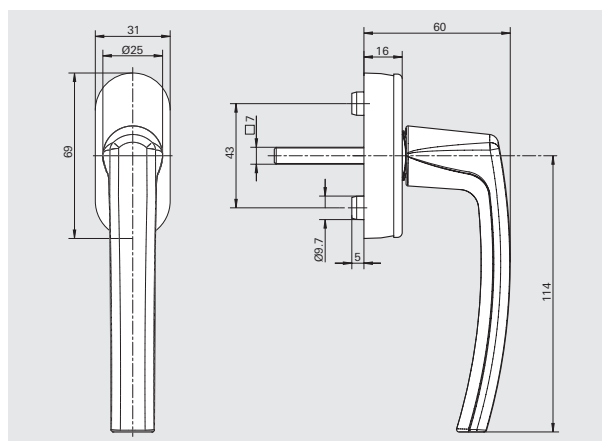

## RotoLine Secustik® window handle, 32mm spindle length, with Ø10mm lugs – without Roto logo

Roto colour no.	Handle and escutcheon cover colour	Base plate colour	Material number	Supply-Service Grade
R 01.1	silver, anodised	silver-grey	<b>351 756</b>	3
R 01.2	champagne, anodised	beige	<b>351 757</b>	3
R 01.3	titanium matt, anodised	grey	<b>351 758</b>	3
R 04.1	grey-brown; RAL 8019	brown	<b>351 759</b>	3
R 05.3	medium bronze, anodised	medium-bronze	<b>351 760</b>	3
R 05.5	bronze, anodised	bronze	<b>351 761</b>	3
R 07.2	traffic-white; RAL 9016	white	<b>351 763</b>	3

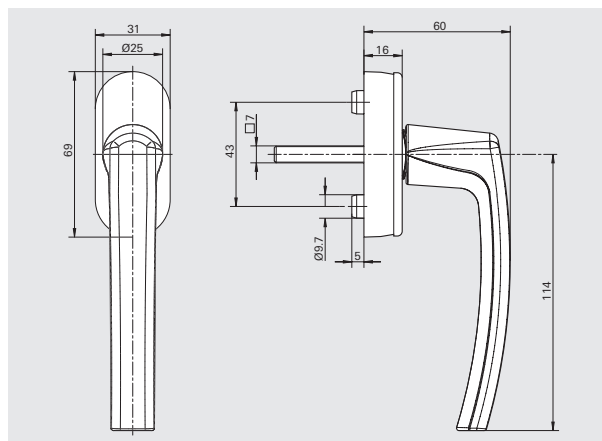

## RotoLine Secustik® window handle, 37mm spindle length, with Ø10mm lugs – without Roto logo

Roto colour no.	Handle and escutcheon cover colour	Base plate colour	Material number	Supply-Service Grade
R 01.1	silver, anodised	silver-grey	<b>351 737</b>	3
R 01.2	champagne, anodised	beige	<b>351 738</b>	3
R 01.3	titanium matt, anodised	grey	<b>351 739</b>	3
R 04.1	grey-brown; RAL 8019	brown	<b>351 740</b>	3
R 05.3	medium bronze, anodised	medium-bronze	<b>351 741</b>	3
R 05.5	bronze, anodised	bronze	<b>351 742</b>	3
R 07.2	traffic-white; RAL 9016	white	<b>351 744</b>	3

# Roto window handles

## RotoLine window handles without Roto logo – Secustik®

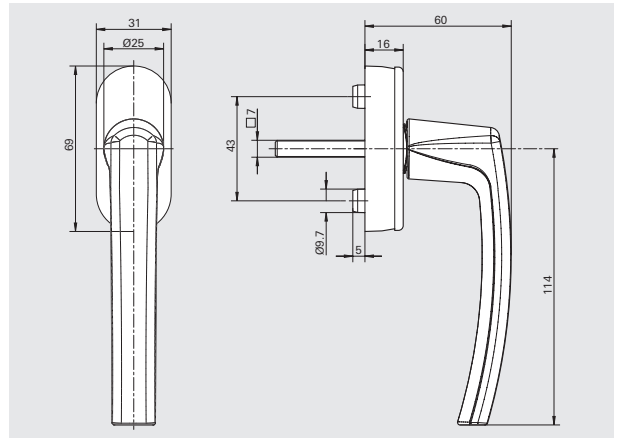

### RotoLine Secustik® window handle, 40mm spindle length, with Ø10mm lugs – without Roto logo

Roto colour no.	Handle and escutcheon cover colour	Base plate colour	Material number	Supply-Service Grade
R 01.1	silver, anodised	silver-grey	<b>363 584</b>	3
R 01.2	champagne, anodised	beige	<b>363 615</b>	3
R 01.3	titanium matt, anodised	grey	<b>363 616</b>	3
R 04.1	grey-brown; RAL 8019	brown	<b>363 617</b>	3
R 05.3	medium bronze, anodised	medium-bronze	<b>363 618</b>	3
R 05.5	bronze, anodised	bronze	<b>363 619</b>	3
R 07.2	traffic-white; RAL 9016	white	<b>363 621</b>	3



# RotoLine window handles without Roto logo – 40Nm lockable

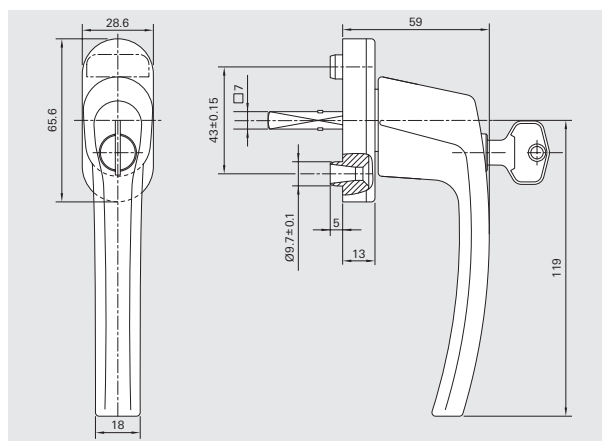

**RotoLine window handle, 40Nm lockable, keyed-alike (K.A.) locking, rotary cylinder**  
30mm spindle length, with Ø10mm lugs, including 1 nickel-plated turn-key – **without Roto logo**

Roto colour no.	Handle and escutcheon cover colour	Base plate colour	Material number	Supply-Service Grade
R 01.1	silver, anodised	silver-grey	<b>228 125</b>	1
R 01.2	champagne, anodised	beige	<b>228 126</b>	2
R 01.3	titanium matt, anodised	grey	<b>228 035</b>	1
R 03.1	brass matt, anodised	brass-colour	<b>228 127</b>	2
R 04.1	grey-brown; RAL 8019	brown	<b>228 037</b>	2
R 05.3	medium bronze, anodised	medium-bronze	<b>228 128</b>	2
R 05.5	bronze, anodised	bronze	<b>228 129</b>	2
R 07.2	traffic-white; RAL 9016	white	<b>228 039</b>	1

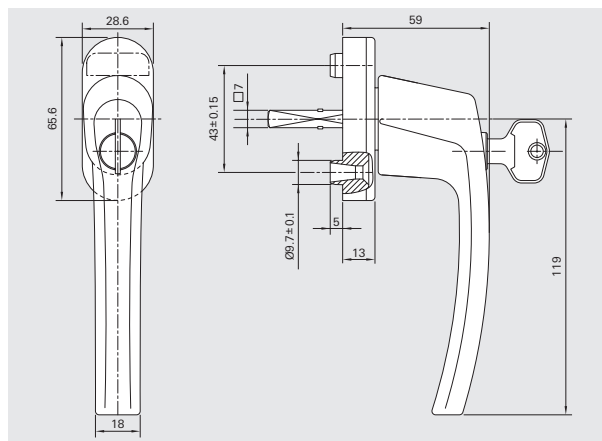

**RotoLine window handle, 40Nm lockable, keyed-alike (K.A.) locking, rotary cylinder**  
35mm spindle length, with Ø10mm lugs, including 1 nickel-plated turn-key – **without Roto logo**

Roto colour no.	Handle and escutcheon cover colour	Base plate colour	Material number	Supply-Service Grade
R 01.1	silver, anodised	silver-grey	<b>228 130</b>	1
R 01.2	champagne, anodised	beige	<b>228 131</b>	2
R 01.3	titanium matt, anodised	grey	<b>228 040</b>	1
R 03.1	brass matt, anodised	brass-colour	<b>228 132</b>	2
R 04.1	grey-brown; RAL 8019	brown	<b>228 042</b>	2
R 05.3	medium bronze, anodised	medium-bronze	<b>228 133</b>	2
R 05.5	bronze, anodised	bronze	<b>228 134</b>	2
R 07.2	traffic-white; RAL 9016	white	<b>228 044</b>	1

# Roto window handles

## RotoLine window handles without Roto logo – 100Nm (DIN) lockable

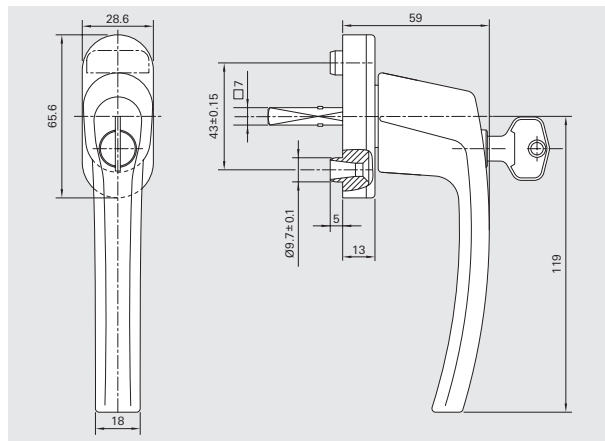

**RotoLine window handle, 100Nm lockable in accordance with DIN V ENV 1627-1630 and DIN 18104-1 standards, keyed-alike (K.A.) locking, push cylinder 30mm spindle length, with Ø10mm lugs, including 1 nickel-plated turn-key – without Roto logo**

Roto colour no.	Handle and escutcheon cover colour	Base plate colour	Material number	Supply-Service Grade
R 01.1	silver, anodised	silver-grey	<b>333 964</b>	1
R 01.2	champagne, anodised	beige	<b>333 965</b>	2
R 01.3	titanium matt, anodised	grey	<b>333 966</b>	1
R 03.1	brass matt, anodised	brass-colour	<b>333 967</b>	2
R 04.1	grey-brown; RAL 8019	brown	<b>333 968</b>	2
R 05.3	medium bronze, anodised	medium-bronze	<b>333 969</b>	2
R 05.5	bronze, anodised	bronze	<b>333 970</b>	2
R 07.2	traffic-white; RAL 9016	white	<b>333 972</b>	1

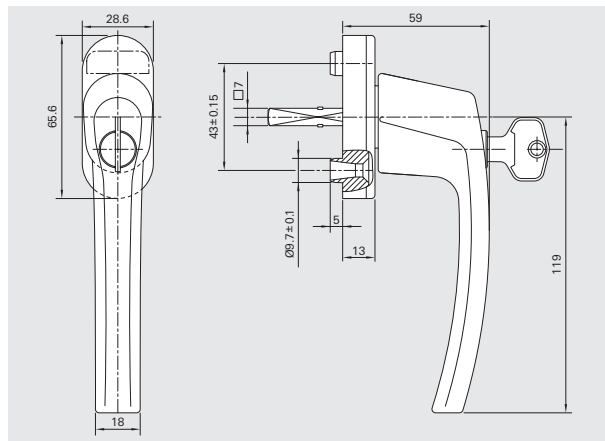

**RotoLine window handle, 100Nm lockable in accordance with DIN V ENV 1627-1630 and DIN 18104-1 standards, keyed-alike (K.A.) locking, push cylinder 35mm spindle length, with Ø10mm lugs, including 1 nickel-plated turn-key – without Roto logo**

Roto colour no.	Handle and escutcheon cover colour	Base plate colour	Material number	Supply-Service Grade
R 01.1	silver, anodised	silver-grey	<b>333 983</b>	1
R 01.2	champagne, anodised	beige	<b>333 984</b>	2
R 01.3	titanium matt, anodised	grey	<b>333 985</b>	1
R 03.1	brass matt, anodised	brass-colour	<b>333 986</b>	2
R 04.1	grey-brown; RAL 8019	brown	<b>333 987</b>	2
R 05.3	medium bronze, anodised	medium-bronze	<b>333 988</b>	2
R 05.5	bronze, anodised	bronze	<b>333 989</b>	2
R 07.2	traffic-white; RAL 9016	white	<b>333 991</b>	1

# RotoLine window handles without Roto logo – 100Nm (DIN) lockable

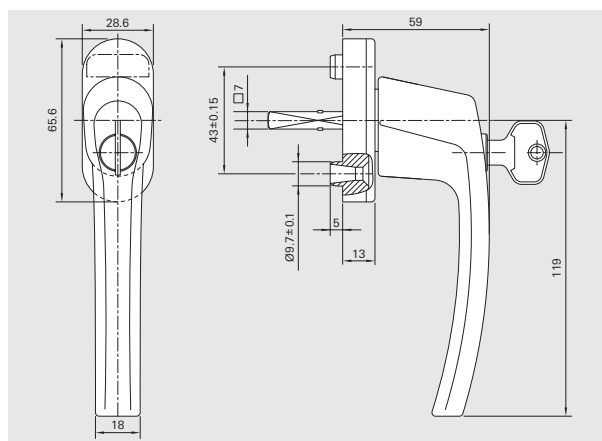

**RotoLine window handle, 100Nm lockable in accordance with DIN V ENV 1627-1630 and DIN 18104-1 standards, keyed-alike (K.A.) locking, push cylinder 40mm spindle length, with Ø10mm lugs, including 1 nickel-plated turn-key – without Roto logo**

Roto colour no.	Handle and escutcheon cover colour	Base plate colour	Material number	Supply-Service Grade
R 01.1	silver, anodised	silver-grey	<b>355 804</b>	1
R 01.3	titanium matt, anodised	grey	<b>355 805</b>	1
R 03.1	brass matt, anodised	brass-colour	<b>364 504</b>	2
R 04.1	grey-brown; RAL 8019	brown	<b>363 255</b>	2
R 05.3	medium bronze, anodised	medium-bronze	<b>364 505</b>	2
R 05.5	bronze, anodised	bronze	<b>364 506</b>	2
R 07.2	traffic-white; RAL 9016	white	<b>355 806</b>	1

# Roto window handles

## RotoLine window handles without Roto logo – Push-button

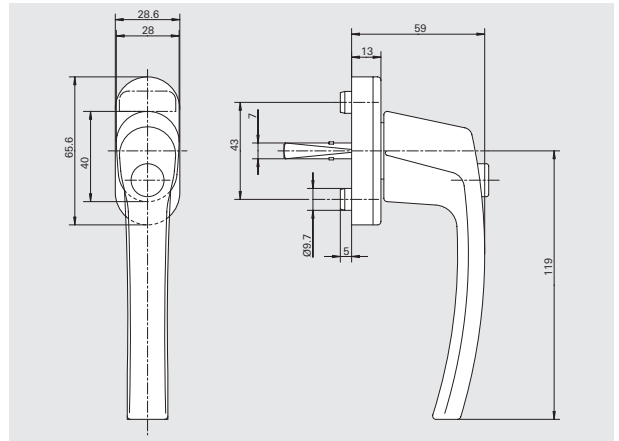

**RotoLine push-button window handle, 30mm spindle length, with Ø10mm lugs – without Roto logo**

Roto colour no.	Handle and escutcheon cover colour	Base plate colour	Material number	Supply-Service Grade
R 01.1	silver, anodised	silver-grey	<b>228 135</b>	1
R 01.2	champagne, anodised	beige	<b>228 136</b>	2
R 01.3	titanium matt, anodised	grey	<b>228 045</b>	1
R 03.1	brass matt, anodised	brass-colour	<b>228 137</b>	2
R 04.1	grey-brown; RAL 8019	brown	<b>228 047</b>	2
R 05.3	medium bronze, anodised	medium-bronze	<b>228 138</b>	2
R 05.5	bronze, anodised	bronze	<b>228 139</b>	2
R 07.2	traffic-white; RAL 9016	white	<b>228 049</b>	1

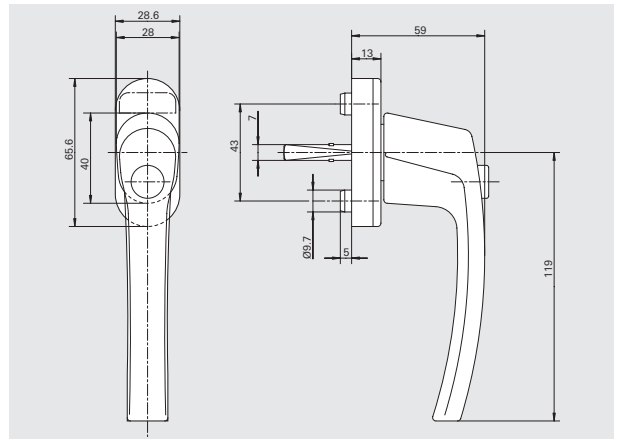

**RotoLine push-button window handle, 35mm spindle length, with Ø10mm lugs – without Roto logo**

Roto colour no.	Handle and escutcheon cover colour	Base plate colour	Material number	Supply-Service Grade
R 01.1	silver, anodised	silver-grey	<b>228 140</b>	1
R 01.2	champagne, anodised	beige	<b>228 141</b>	2
R 01.3	titanium matt, anodised	grey	<b>228 050</b>	1
R 03.1	brass matt, anodised	brass-colour	<b>228 142</b>	2
R 04.1	grey-brown; RAL 8019	brown	<b>228 052</b>	2
R 05.3	medium bronze, anodised	medium-bronze	<b>228 143</b>	2
R 05.5	bronze, anodised	bronze	<b>228 144</b>	2
R 07.2	traffic-white; RAL 9016	white	<b>228 054</b>	1



# RotoLine window handles without Roto logo – Service handle

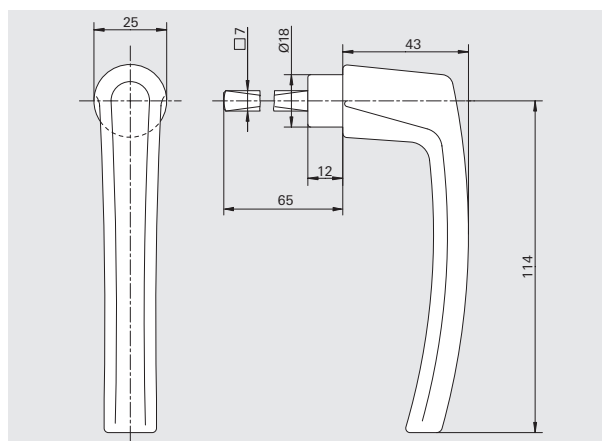

## RotoLine service handle (removable) – without Roto logo

Roto colour no.	Handle and escutcheon cover colour	Base plate colour	Material number	Supply-Service Grade
R 07.2	traffic-white; RAL 9016	white	<b>257 628</b>	1

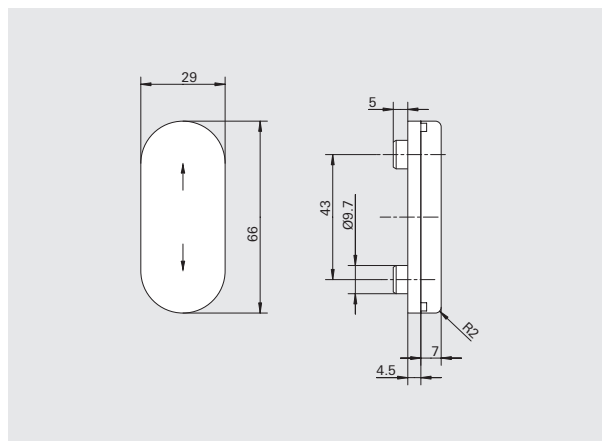

## RotoLine escutcheon cover for service handle, with Ø10mm lugs – without Roto logo

Roto colour no.	Handle and escutcheon cover colour	Base plate colour	Material number	Supply-Service Grade
R 01.1	silver, anodised	silver-grey	<b>228 100</b>	1
R 01.2	champagne, anodised	beige	<b>228 101</b>	2
R 01.3	titanium matt, anodised	grey	<b>228 010</b>	1
R 03.1	brass matt, anodised	brass-colour	<b>228 102</b>	2
R 04.1	grey-brown; RAL 8019	brown	<b>228 012</b>	2
R 05.3	medium bronze, anodised	medium-bronze	<b>228 103</b>	2
R 05.5	bronze, anodised	bronze	<b>228 104</b>	2
R 07.2	traffic-white; RAL 9016	white	<b>228 014</b>	1



# RotoLine door handle set – Escutcheon-cover version

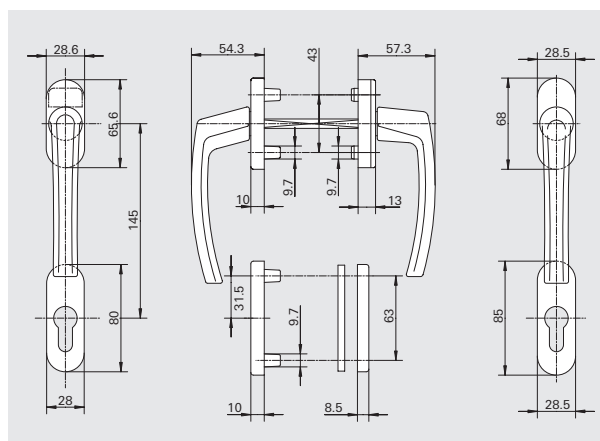

## RotoLine door handle set for internal and external operation

Roto colour no.	Handle and escutcheon cover colour	Base plate colour	Material number	Supply-Service Grade
R 01.1	silver, anodised	silver-grey	<b>228 380</b>	1
R 01.2	champagne, anodised	beige	<b>228 381</b>	2
R 01.3	titanium matt, anodised	grey	<b>228 333</b>	1
R 03.1	brass matt, anodised	brass-colour	<b>228 382</b>	2
R 04.1	grey-brown; RAL 8019	brown	<b>228 335</b>	2
R 05.3	medium bronze, anodised	medium-bronze	<b>228 383</b>	2
R 05.5	bronze, anodised	bronze	<b>228 384</b>	2
R 07.2	traffic-white; RAL 9016	white	<b>228 337</b>	1

**Window handle:** 43mm hole distance, 114mm length

Outside: 58mm high, with threaded insert

Inside: 58mm high, with Ø10mm lugs

**Escutcheon cover:** 63mm hole distance, 31.5mm profile-cylinder distance

Outside: Security escutcheon cover, with profile-cylinder hole, with Ø10mm screw-fixing lugs

Inside: Standard escutcheon cover, with profile-cylinder hole, without lugs

**Fixing screws:** M5 x 100mm with notches for door thicknesses from 56 to 96mm

**Spindle:** Enclosed in packaging for door thicknesses up to 78mm. (For 79 to 96mm door thickness; refer to window handle accessories to order a separate 150mm long spindle)

# RotoLine door handle set – Escutcheon-cover version

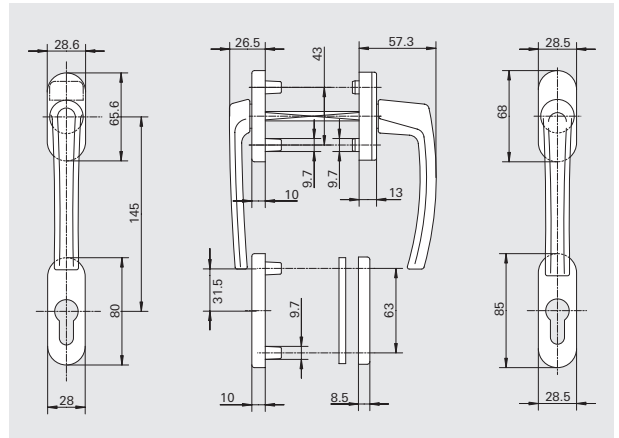

## RotoLine door handle set for internal and external operation – lower handle outside for roller shutters

Roto colour no.	Handle and escutcheon cover colour	Base plate colour	Material number	Supply-Service Grade
R 01.1	silver, anodised	silver-grey	<b>228 390</b>	1
R 01.2	champagne, anodised	beige	<b>228 391</b>	2
R 01.3	titanium matt, anodised	grey	<b>228 345</b>	1
R 03.1	brass matt, anodised	brass-colour	<b>228 392</b>	2
R 04.1	grey-brown; RAL 8019	brown	<b>228 347</b>	2
R 05.3	medium bronze, anodised	medium-bronze	<b>228 393</b>	2
R 05.5	bronze, anodised	bronze	<b>228 394</b>	2
R 07.2	traffic-white; RAL 9016	white	<b>228 349</b>	1

**Window handle:** 43mm hole distance, 114mm length

Outside: 30mm high, with threaded insert

Inside: 58mm high, with Ø10mm lugs

**Escutcheon cover:** 63mm hole distance, 31.5mm profile-cylinder distance

Outside: Security escutcheon cover, with profile-cylinder hole, with Ø10mm screw-fixing lugs

Inside: Standard escutcheon cover, with profile-cylinder hole, without lugs

**Fixing screws:** M5 x 100mm with notches for door thicknesses from 56 to 96mm

**Spindle:** Enclosed in packaging for door thicknesses up to 78mm. (For 79 to 96mm door thickness; refer to window handle accessories to order a separate 150mm long spindle)



## Escutcheon cover & long-plate version

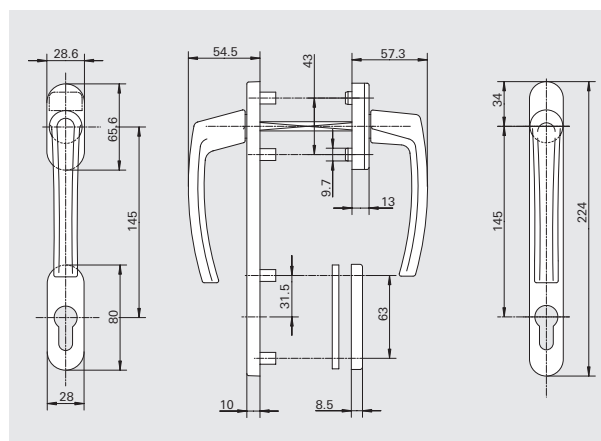

### RotoLine door handle set with long, flat long-plate outside – handle and profile-cylinder escutcheon cover inside

Roto colour no.	Handle and escutcheon cover colour	Base plate colour	Material number	Supply-Service Grade
R 01.1	silver, anodised	silver-grey	<b>228 385</b>	1
R 01.2	champagne, anodised	beige	<b>228 386</b>	2
R 01.3	titanium matt, anodised	grey	<b>228 339</b>	1
R 03.1	brass matt, anodised	brass-colour	<b>228 387</b>	2
R 04.1	grey-brown; RAL 8019	brown	<b>228 341</b>	2
R 05.3	medium bronze, anodised	medium-bronze	<b>228 388</b>	2
R 05.5	bronze, anodised	bronze	<b>228 389</b>	2
R 07.2	traffic-white; RAL 9016	white	<b>228 343</b>	1

**Window handle:** 43mm hole distance, 114mm length  
 Outside: 55mm high, mounted on long-plate  
 Inside: 58mm high, with Ø10mm lugs

**Standard escutcheon cover inside:** 63mm hole distance, with profile-cylinder hole, 31.5mm profile-cylinder distance, without lugs

**Long-plate outside:** slim, flat, 10mm high, with profile-cylinder hole, 145mm profile-cylinder distance, with Ø10mm screw-fixing lugs

**Fixing screws:** M5 x 100mm with notches for door thicknesses from 56 to 96mm

**Spindle:** Enclosed in packaging for door thicknesses up to 78mm. (For 79 to 96mm door thickness; refer to window handle accessories to order a separate 150mm long spindle)

# RotoLine door handle set

## Escutcheon cover & angled long-plate version (milled)



Inside

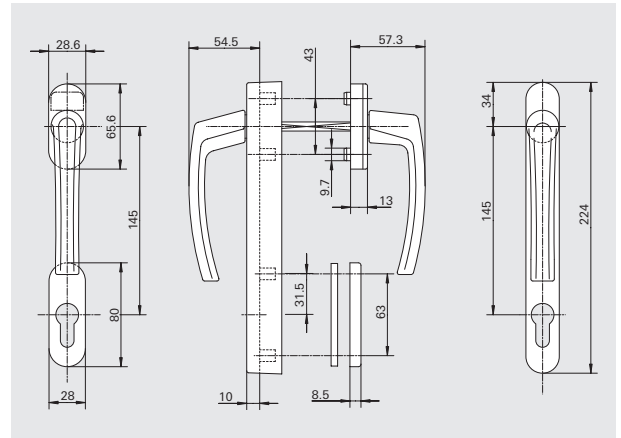

Outside

### RotoLine door handle set with long, angular-shaped long-plate outside – handle and profile-cylinder escutcheon cover inside

Roto colour no.	Handle and escutcheon cover colour	Base plate colour	Material number	Supply-Service Grade
R 01.1	silver, anodised	silver-grey	L 228 400	3
			R 228 401	3
R 01.2	champagne, anodised	beige	L 228 402	3
			R 228 403	3
R 01.3	titanium matt, anodised	grey	L 228 358	3
			R 228 359	3
R 04.1	grey-brown; RAL 8019	brown	L 228 362	3
			R 228 363	3
R 05.3	medium bronze, anodised	medium-bronze	L 228 408	3
			R 228 409	3
R 05.5	bronze, anodised	bronze	L 228 410	3
			R 228 411	3
R 07.2	traffic-white; RAL 9016	white	L 228 366	3
			R 228 367	3

**Window handle:** 43mm hole distance, 114mm length  
 Outside: 55mm high, mounted on **milled** long-plate  
 Inside: 58mm high, with Ø10mm lugs

**Standard escutcheon cover inside:** 63mm hole distance, with profile-cylinder hole, 31.5mm profile-cylinder distance, without lugs

**Long-plate outside:** slim, milled at an angle for flush profiles according to the dimensions from the copy-template enquiry, with profile-cylinder hole, 145mm profile-cylinder distance, with Ø10mm screw-fixing lugs. Upon ordering; please state whether left or right handed.

**Fixing screws:** M5 x 100mm with notches for door thicknesses from 56 to 96mm

**Spindle:** Enclosed in packaging for door thicknesses up to 78mm. (For 79 to 96mm door thickness; refer to window handle accessories to order a separate 150mm long spindle)

## Escutcheon cover & long-plate version

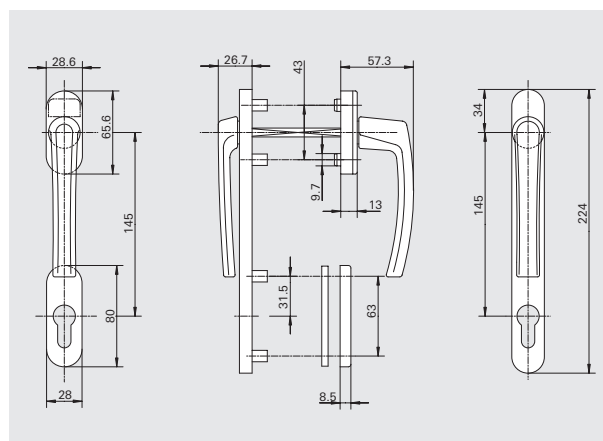

### RotoLine door handle set with long, flat long-plate outside and low handle for roller shutters

Roto colour no.	Handle and escutcheon cover colour	Base plate colour	Material number	Supply-Service Grade
R 01.1	silver, anodised	silver-grey	<b>228 395</b>	1
R 01.2	champagne, anodised	beige	<b>228 396</b>	2
R 01.3	titanium matt, anodised	grey	<b>228 351</b>	1
R 03.1	brass matt, anodised	brass-colour	<b>228 397</b>	2
R 04.1	grey-brown; RAL 8019	brown	<b>228 353</b>	2
R 05.3	medium bronze, anodised	medium-bronze	<b>228 398</b>	2
R 05.5	bronze, anodised	bronze	<b>228 399</b>	2
R 07.2	traffic-white; RAL 9016	white	<b>228 355</b>	1

**Window handle:** 43mm hole distance, 114mm length  
 Outside: 30mm high, on unmilled long-plate  
 Inside: 58mm high, with Ø10mm lugs

**Standard escutcheon cover inside:** 63mm hole distance, with profile-cylinder hole, 31.5mm profile-cylinder distance, without lugs

**Long-plate outside:** slim, flat, unmilled 10mm high, with profile-cylinder hole, 145mm profile-cylinder distance, with Ø10mm screw-fixing lugs

**Fixing screws:** M5 x 100mm with notches for door thicknesses from 56 to 96mm

**Spindle:** Enclosed in packaging for door thicknesses up to 78mm. (For 79 to 96mm door thickness; refer to window handle accessories to order a separate 150mm long spindle)

# RotoLine door handle set

## Escutcheon cover & angled long-plate version (milled)

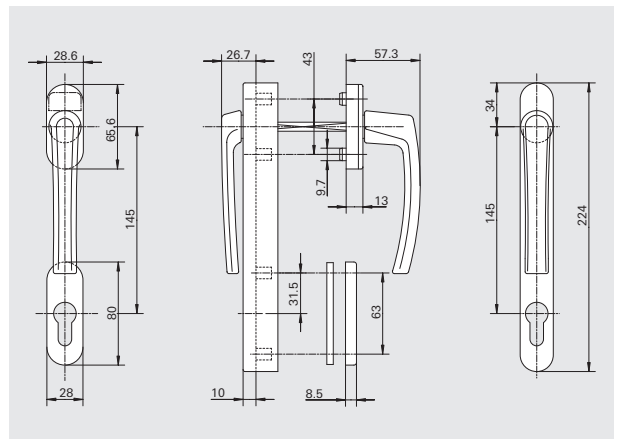

### RotoLine door handle set with long, angular-shaped long-plate outside and low handle for roller shutters

Roto colour no.	Handle and escutcheon cover colour	Base plate colour	Material number	Supply-Service Grade
R 01.1	silver, anodised	silver-grey	L 228 412	3
			R 228 413	3
R 01.2	champagne, anodised	beige	L 228 414	3
			R 228 415	3
R 03.1	brass matt, anodised	brass-colour	L 228 418	3
			R 228 419	3
R 05.3	medium bronze, anodised	medium-bronze	L 228 420	3
			R 228 421	3
R 05.5	bronze, anodised	bronze	L 228 422	3
			R 228 423	3
R 07.2	traffic-white; RAL 9016	white	L 228 378	3
			R 228 379	3

**Window handle:** 43mm hole distance, 114mm length  
**Outside:** 30mm high, mounted on **milled** long-plate  
**Inside:** 58mm high, with Ø10mm lugs

**Standard escutcheon cover inside:** 63mm hole distance, with profile-cylinder hole, 31.5mm profile-cylinder distance, without lugs

**Long-plate outside:** slim, milled at an angle for flush profiles according to the dimensions from the copy-template enquiry, with profile-cylinder hole, 145mm profile-cylinder distance, with Ø10mm screw-fixing lugs. Upon ordering, please state whether left or right handed.

**Fixing screws:** M5 x 100mm with notches for door thicknesses from 56 to 96mm

**Spindle:** Enclosed in packaging for door thicknesses up to 78mm. (For 79 to 96mm door thickness; refer to window handle accessories to order a separate 150mm long spindle)

# Copy-template: Enquiry for profile-related (milled) angular-shaped long-plate handles



Please fax the following enquiry:

Please forward to your  
Roto Frank AG subsidiary

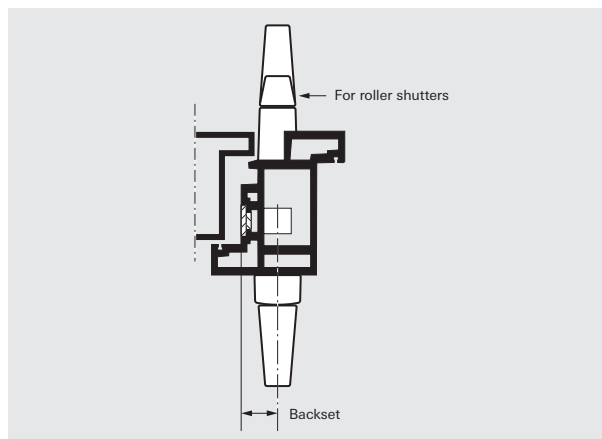

- ☐ Your Roto subsidiary is responsible for pricing.
- ☐ The lead-time of the requested door handle set shall be communicated with this enquiry.
- ☐ Ordering is processed via a dealer of your choice.

## Angled long-plate door handle set enquiry, adapted to flush PVC profiles

Material number of left-handed door handle set **LH** \_\_\_\_\_ Pieces \_\_\_\_\_

Material number of right-handed door handle set **RH** \_\_\_\_\_ Pieces \_\_\_\_\_

Profile system \_\_\_\_\_

Sash profile number \_\_\_\_\_

Backset \_\_\_\_\_

## Your address:

Company \_\_\_\_\_

Contact person \_\_\_\_\_

Street / House no. \_\_\_\_\_

Postal code /  
Town / Country \_\_\_\_\_

Telephone \_\_\_\_\_





# Roto window handles

## RotoLine cranked handles

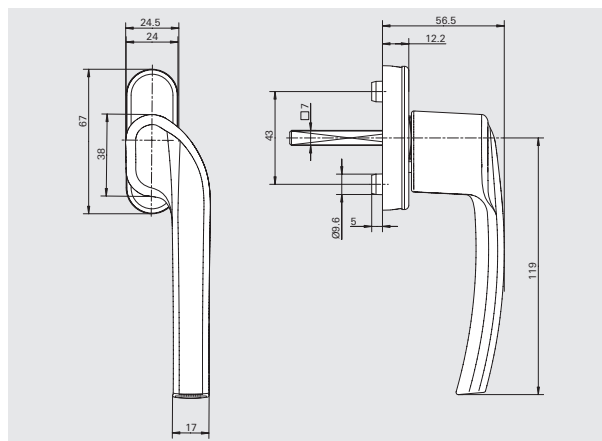

**RotoLine cranked handle, 43mm spindle length, with Ø10mm lugs, 24mm escutcheon cover – without Roto logo**

Roto colour no.	Handle and escutcheon cover colour	Base plate colour	Material number	Supply-Service Grade
R 01.1	silver, anodised	silver-grey	L <b>375 318</b> R <b>375 811</b>	3 3
R 01.3	titanium matt, anodised	beige	L <b>375 319</b> R <b>375 814</b>	3 3
R 07.2	traffic-white; RAL 9016	white	L <b>375 320</b> R <b>375 816</b>	3 3

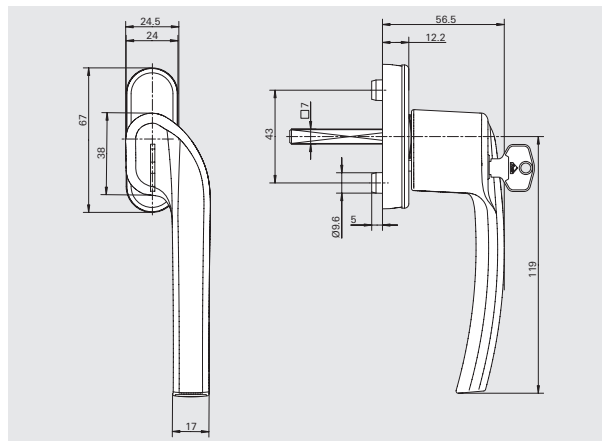

**RotoLine cranked handle, lockable – keyed-alike locking, push cylinder – 43mm spindle length, with Ø10mm lugs, 24mm escutcheon cover, including 1 nickel-plated turn-key – without Roto logo, with SKG\* logo**

Roto colour no.	Handle and escutcheon cover colour	Base plate colour	Material number	Supply-Service Grade
R 01.1	silver, anodised	silver-grey	L <b>375 322</b> R <b>375 819</b>	3 3
R 01.3	titanium matt, anodised	beige	L <b>375 325</b> R <b>375 820</b>	3 3
R 07.2	traffic-white; RAL 9016	white	L <b>375 330</b> R <b>375 821</b>	3 3



# Window / balcony-door handle set accessories

## Exterior-handles

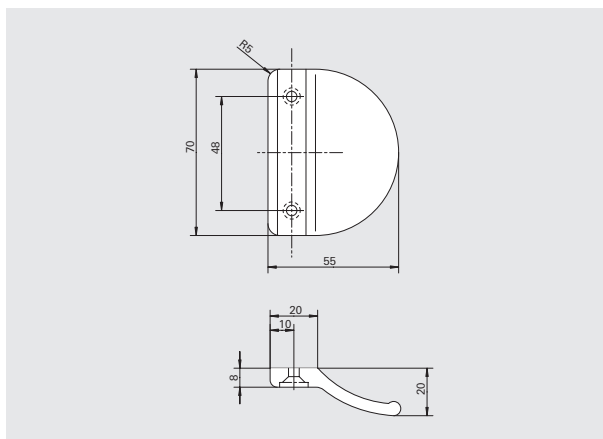

### RotoLine PVC exterior pull-handle for balcony doors

Roto colour no.	Handle and escutcheon cover colour	Material number	Supply-Service Grade
R 04.1	grey-brown; RAL 8019	<b>228 258</b>	2
R 07.2	traffic-white; RAL 9016	<b>228 259</b>	2

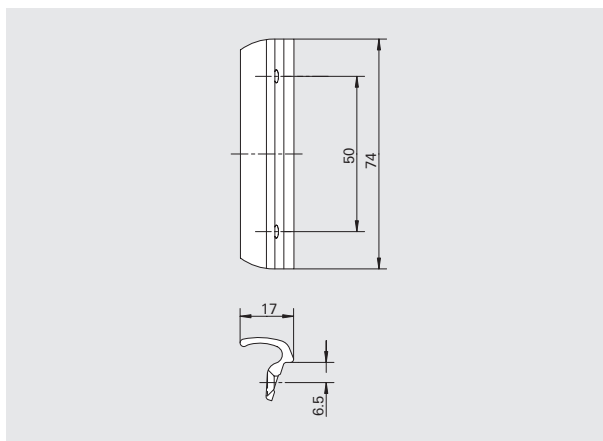

### RotoLine aluminium exterior pull-handle for balcony doors

Roto colour no.	Handle and escutcheon cover colour	Material number	Supply-Service Grade
R 01.1	silver, anodised	<b>355 837</b>	1
R 05.3	medium bronze, anodised	<b>355 838</b>	1
R 07.2	traffic-white; RAL 9016	<b>355 839</b>	1

# Roto window handles

## Window handle accessories



Replacement / spare key 1G1 for all Roto handles

Material number **257 830**



**Tilt&Turn projecting-limiter with corner-bracket;** corner-bracket adapted to the Roto escutcheon-cover design

Roto colour no.	Tilt&Turn projecting-limiter colour	Corner-bracket colour	Material number	Supply-Service Grade
R 04.1	grey-brown; RAL 8019	silver/nickel-plated	<b>245 686</b>	2
R 07.2	traffic-white; RAL 9016	silver/nickel-plated	<b>245 685</b>	2



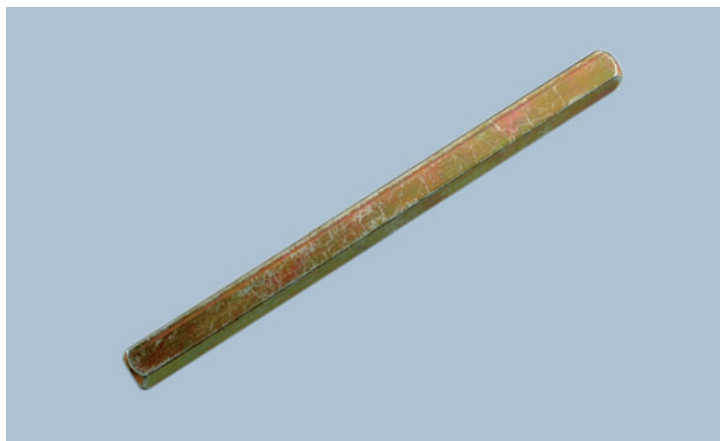

**Spindle, 150mm long**

Material number **287 824**

S.S.G. 2



# Roto window handles

## DecoLine window handles with Roto logo – Secustik®

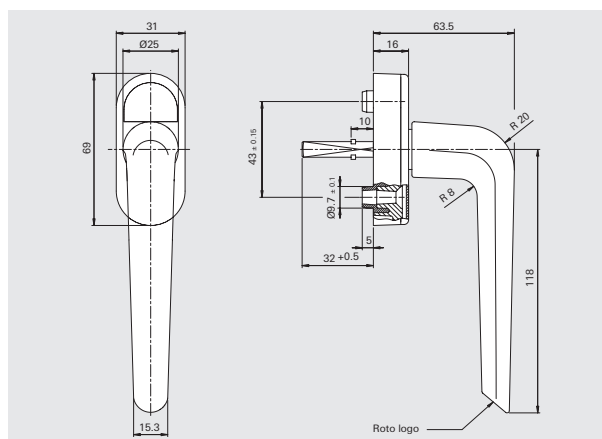

### DecoLine Secustik® window handle, 32mm spindle length, with Ø10mm lugs – with Roto logo

Roto colour no.	Handle and escutcheon cover colour	Base plate colour	Material number	Supply-Service Grade
R 01.1	silver, anodised	silver-grey	<b>261 953</b>	3
R 01.2	champagne, anodised	beige	<b>281 358</b>	3
R 01.3	titanium matt, anodised	grey	<b>261 954</b>	3
R 03.1	brass matt, anodised	brass-colour	<b>281 359</b>	3
R 05.3	medium bronze, anodised	medium-bronze	<b>261 955</b>	3
R 05.5	bronze, anodised	bronze	<b>281 360</b>	3
R 07.2	traffic-white; RAL 9016	white	<b>261 956</b>	3

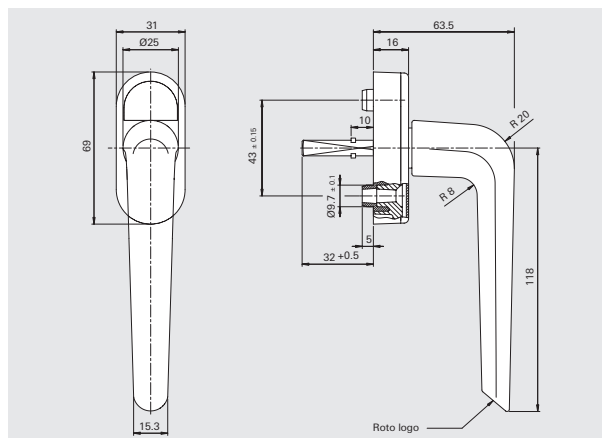

### DecoLine Secustik® window handle, 37mm spindle length, with Ø10mm lugs – with Roto logo

Roto colour no.	Handle and escutcheon cover colour	Base plate colour	Material number	Supply-Service Grade
R 01.1	silver, anodised	silver-grey	<b>289 212</b>	3
R 01.2	champagne, anodised	beige	<b>289 214</b>	3
R 01.3	titanium matt, anodised	grey	<b>289 216</b>	3
R 03.1	brass matt, anodised	brass-colour	<b>289 215</b>	3
R 05.3	medium bronze, anodised	medium-bronze	<b>289 218</b>	3
R 05.5	bronze, anodised	bronze	<b>289 217</b>	3
R 07.2	traffic-white; RAL 9016	white	<b>289 219</b>	3

# Roto window handles

## DecoLine window handles with Roto logo – 100Nm (DIN) lockable

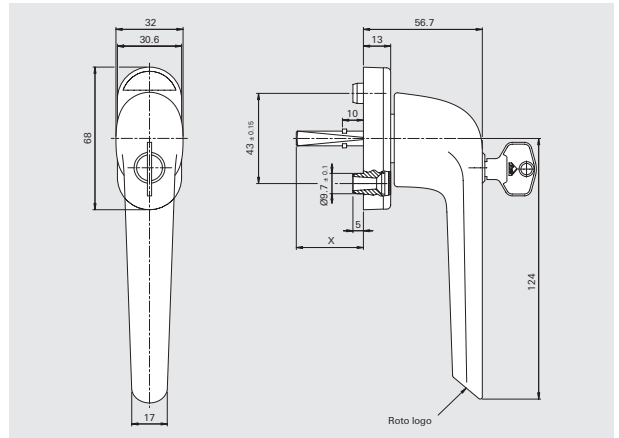

**DecoLine window handle, 100Nm** lockable in accordance with DIN V ENV 1627-1630 and DIN 18104-1 standards, **keyed-alike locking**, 32mm spindle length, including 1 nickel-plated turn-key, with Ø10mm lugs – **with Roto logo**

Roto colour no.	Handle and escutcheon cover colour	Base plate colour	Material number	Supply-Service Grade
R 01.1	silver, anodised	silver-grey	<b>261 958</b>	3
R 01.2	champagne, anodised	beige	<b>281 372</b>	3
R 01.3	titanium matt, anodised	grey	<b>261 959</b>	3
R 03.1	brass matt, anodised	brass-colour	<b>281 373</b>	3
R 05.3	medium bronze, anodised	medium-bronze	<b>261 960</b>	3
R 05.5	bronze, anodised	bronze	<b>281 374</b>	3
R 07.2	traffic-white; RAL 9016	white	<b>261 961</b>	3

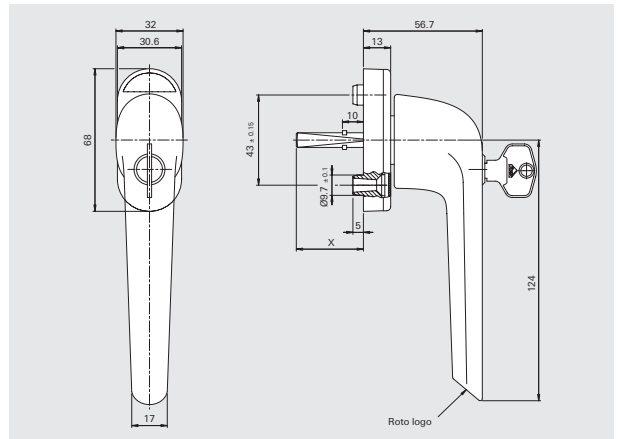

**DecoLine window handle, 100Nm** lockable in accordance with DIN V ENV 1627-1630 and DIN 18104-1 standards, **keyed-alike locking**, 37mm spindle length, including 1 nickel-plated turn-key, with Ø10mm lugs – **with Roto logo**

Roto colour no.	Handle and escutcheon cover colour	Base plate colour	Material number	Supply-Service Grade
R 01.1	silver, anodised	silver-grey	<b>337 494</b>	3
R 04.1	grey-brown; RAL 8019	brown	<b>343 725</b>	3
R 07.2	traffic-white; RAL 9016	white	<b>337 443</b>	3

# RotoLine window handles with Roto logo – Standard

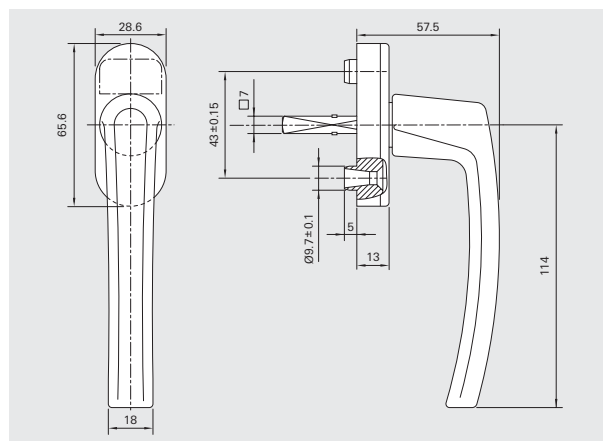

## RotoLine window handle, 30mm spindle length, with Ø10mm lugs – with Roto logo

Roto colour no.	Handle and escutcheon cover colour	Base plate colour	Material number	Supply-Service Grade
R 01.1	silver, anodised	silver-grey	<b>227 897</b>	1
R 01.2	champagne, anodised	beige	<b>227 899</b>	2
R 01.3	titanium matt, anodised	grey	<b>227 781</b>	1
R 03.1	brass matt, anodised	brass-colour	<b>227 901</b>	2
R 04.1	grey-brown; RAL 8019	brown	<b>227 786</b>	2
R 05.3	medium bronze, anodised	medium-bronze	<b>227 903</b>	2
R 05.5	bronze, anodised	bronze	<b>227 905</b>	2
R 07.2	traffic-white; RAL 9016	white	<b>227 790</b>	1

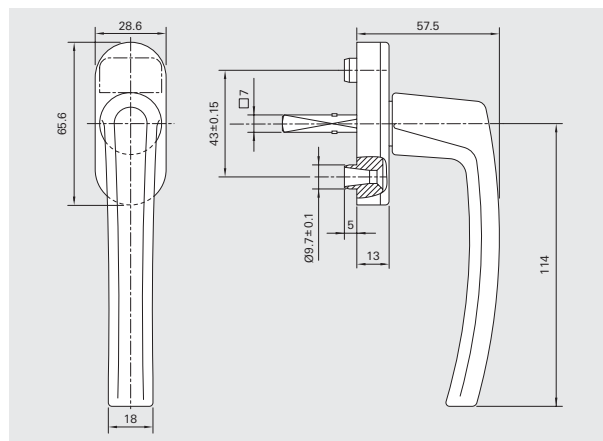

## RotoLine window handle, 35mm spindle length, with Ø10mm lugs – with Roto logo

Roto colour no.	Handle and escutcheon cover colour	Base plate colour	Material number	Supply-Service Grade
R 01.1	silver, anodised	silver-grey	<b>227 907</b>	1
R 01.2	champagne, anodised	beige	<b>227 909</b>	2
R 01.3	titanium matt, anodised	grey	<b>227 796</b>	1
R 03.1	brass matt, anodised	brass-colour	<b>227 911</b>	2
R 03.2	vollmessing, poliert	brass-colour	<b>227 801</b>	2
R 04.1	grey-brown; RAL 8019	brown	<b>227 803</b>	2
R 05.3	medium bronze, anodised	medium-bronze	<b>227 913</b>	2
R 05.5	bronze, anodised	bronze	<b>227 915</b>	2
R 07.2	traffic-white; RAL 9016	white	<b>227 808</b>	1



# Roto window handles

## RotoLine window handles with Roto logo – Secustik® & with 45° click

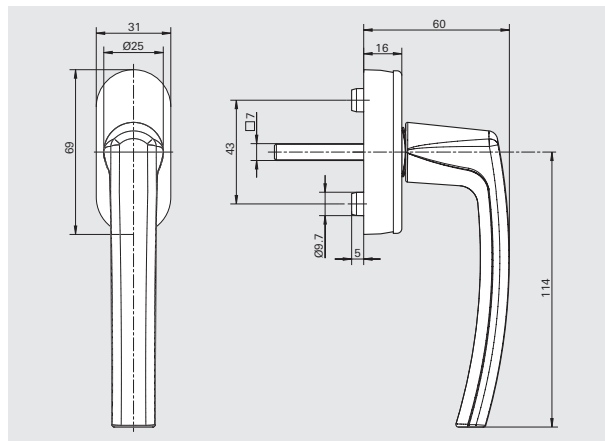

**RotoLine Secustik® window handle, 45° click, 32mm spindle length, with Ø10mm lugs – with Roto logo**

Roto colour no.	Handle and escutcheon cover colour	Base plate colour	Material number	Supply-Service Grade
R 01.1	silver, anodised	silver-grey	<b>374 117</b>	3
R 01.2	champagne, anodised	beige	<b>374 118</b>	3
R 01.3	titanium matt, anodised	grey	<b>374 119</b>	3
R 04.1	grey-brown; RAL 8019	brown	<b>374 120</b>	3
R 05.3	medium bronze, anodised	medium-bronze	<b>374 121</b>	3
R 05.5	bronze, anodised	bronze	<b>374 122</b>	3
R 07.2	traffic-white; RAL 9016	white	<b>374 123</b>	3

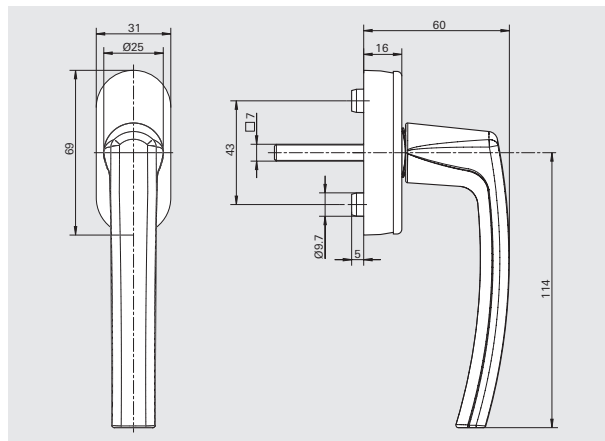

**RotoLine Secustik® window handle, 45° click, 37mm spindle length, with Ø10mm lugs – with Roto logo**

Roto colour no.	Handle and escutcheon cover colour	Base plate colour	Material number	Supply-Service Grade
R 01.1	silver, anodised	silver-grey	<b>374 124</b>	3
R 01.2	champagne, anodised	beige	<b>374 125</b>	3
R 01.3	titanium matt, anodised	grey	<b>374 126</b>	3
R 04.1	grey-brown; RAL 8019	brown	<b>374 127</b>	3
R 05.3	medium bronze, anodised	medium-bronze	<b>374 128</b>	3
R 05.5	bronze, anodised	bronze	<b>374 129</b>	3
R 07.2	traffic-white; RAL 9016	white	<b>374 130</b>	3

# RotoLine window handles with Roto logo – Secustik® & with 45° click

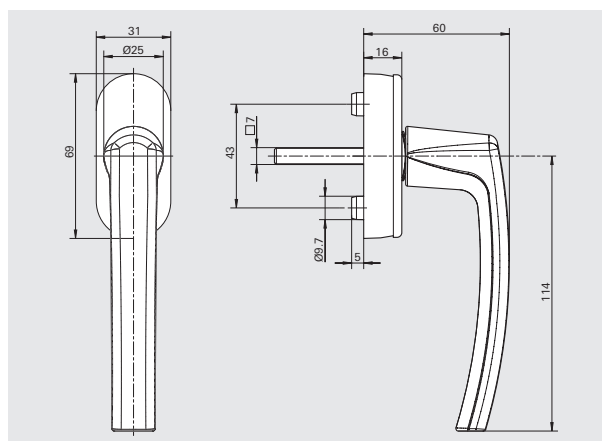

## RotoLine Secustik® window handle, 45° click, 40mm spindle length, with Ø10mm lugs – with Roto logo

Roto colour no.	Handle and escutcheon cover colour	Base plate colour	Material number	Supply-Service Grade
R 01.1	silver, anodised	silver-grey	<b>374 131</b>	3
R 01.2	champagne, anodised	beige	<b>374 132</b>	3
R 01.3	titanium matt, anodised	grey	<b>374 133</b>	3
R 04.1	grey-brown; RAL 8019	brown	<b>374 134</b>	3
R 05.3	medium bronze, anodised	medium-bronze	<b>374 135</b>	3
R 05.5	bronze, anodised	bronze	<b>374 136</b>	3
R 07.2	traffic-white; RAL 9016	white	<b>374 137</b>	3

# Roto window handles

## RotoLine window handles with Roto logo – 40Nm lockable

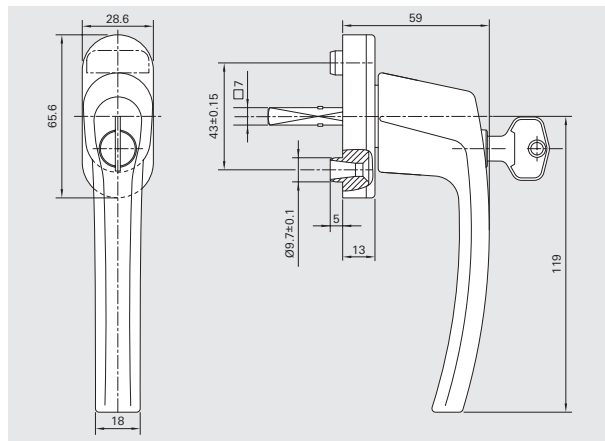

**RotoLine window handle, 40Nm lockable, keyed-alike locking, rotary cylinder, 30mm spindle length, including 1 nickel-plated turn-key, with Ø10mm lugs – with Roto logo**

Roto colour no.	Handle and escutcheon cover colour	Base plate colour	Material number	Supply-Service Grade
R 01.1	silver, anodised	silver-grey	<b>227 962</b>	1
R 01.2	champagne, anodised	beige	<b>227 963</b>	2
R 01.3	titanium matt, anodised	grey	<b>227 863</b>	1
R 03.1	brass matt, anodised	brass-colour	<b>227 964</b>	2
R 04.1	grey-brown; RAL 8019	brown	<b>227 866</b>	2
R 05.3	medium bronze, anodised	medium-bronze	<b>227 965</b>	2
R 05.5	bronze, anodised	bronze	<b>227 966</b>	2
R 07.2	traffic-white; RAL 9016	white	<b>227 868</b>	1

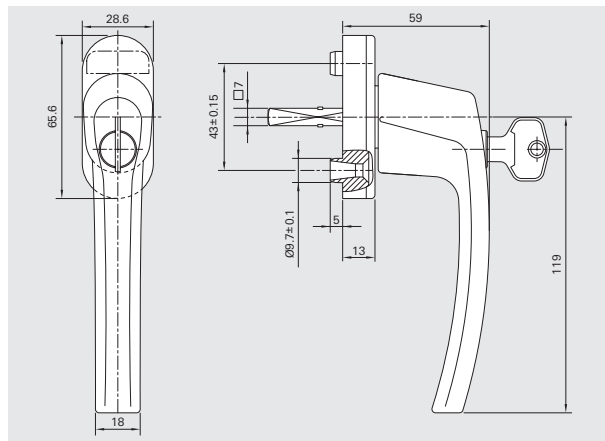

**RotoLine window handle, 40Nm lockable, keyed-alike locking, rotary cylinder, 35mm spindle length, including 1 nickel-plated turn-key, with Ø10mm lugs – with Roto logo**

Roto colour no.	Handle and escutcheon cover colour	Base plate colour	Material number	Supply-Service Grade
R 01.1	silver, anodised	silver-grey	<b>227 967</b>	1
R 01.2	champagne, anodised	beige	<b>227 968</b>	2
R 01.3	titanium matt, anodised	grey	<b>227 871</b>	1
R 03.1	brass matt, anodised	brass-colour	<b>227 969</b>	2
R 04.1	grey-brown; RAL 8019	brown	<b>227 874</b>	2
R 05.3	medium bronze, anodised	medium-bronze	<b>227 970</b>	2
R 05.5	bronze, anodised	bronze	<b>227 971</b>	2
R 07.2	traffic-white; RAL 9016	white	<b>227 876</b>	1

## RotoLine window handles with Roto logo – Tilt-First\*

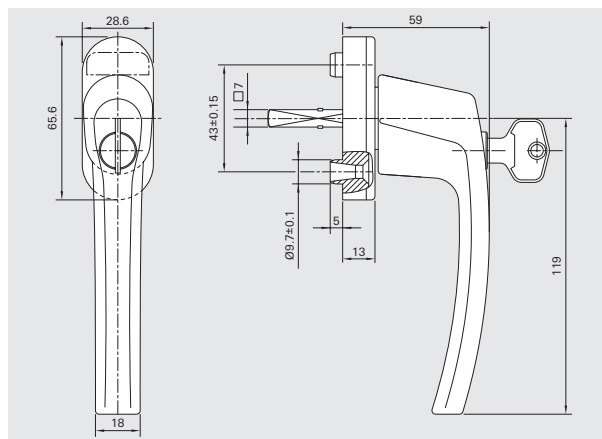

**RotoLine Tilt-First window handle, lockable, keyed-alike locking, rotary cylinder, 32mm spindle length, including 1 nickel-plated turn-key, with Ø10mm lugs – with Roto logo**

Roto colour no.	Handle and escutcheon cover colour	Base plate colour	Material number	Supply-Service Grade
R 01.1	silver, anodised	silver-grey	<b>335 309</b>	3
R 01.2	champagne, anodised	beige	<b>335 310</b>	3
R 01.3	titanium matt, anodised	grey	<b>335 314</b>	3
R 07.2	traffic-white; RAL 9016	white	<b>335 313</b>	3

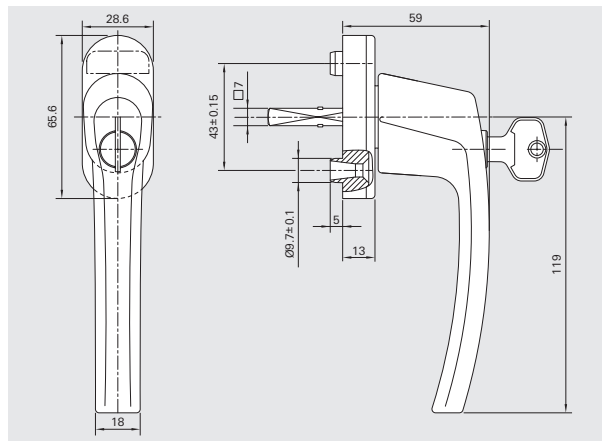

**RotoLine Tilt-First window handle, lockable, keyed-alike locking, rotary cylinder, 37mm spindle length, including 1 nickel-plated turn-key, with Ø10mm lugs – with Roto logo**

Roto colour no.	Handle and escutcheon cover colour	Base plate colour	Material number	Supply-Service Grade
R 01.1	silver, anodised	silver-grey	<b>347 800</b>	3
R 04.1	grey-brown; RAL 8019	brown	<b>347 801</b>	3
R 07.2	traffic-white; RAL 9016	white	<b>347 802</b>	3

\* in connection with Tilt-First sash stay and Tilt-First striker

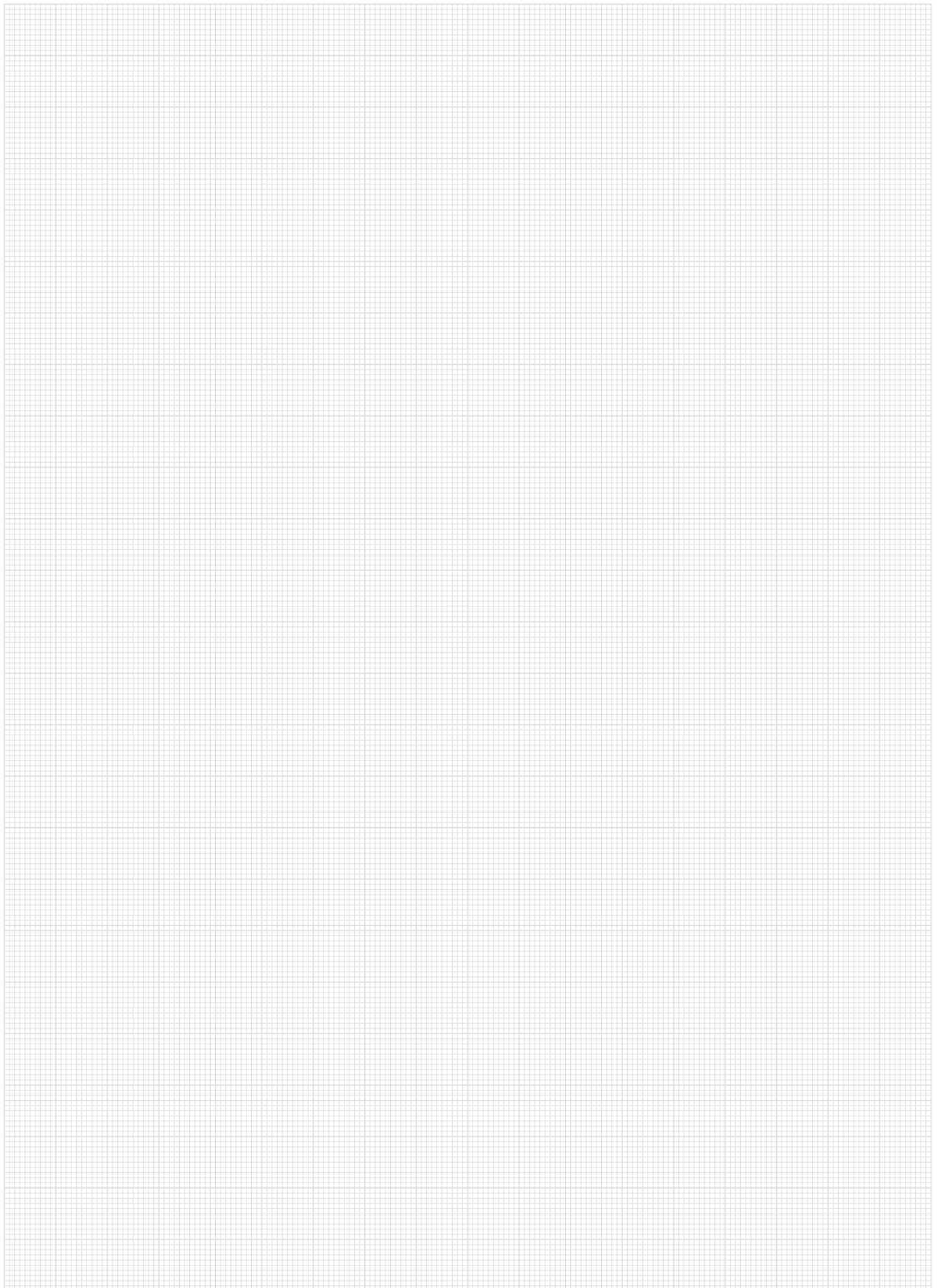



Please request the detailed documentation specifying the order number.



Order no.  
BK 10 GB  
for PVC

not depicted:  
Order no.  
BK 9 GB  
for timber

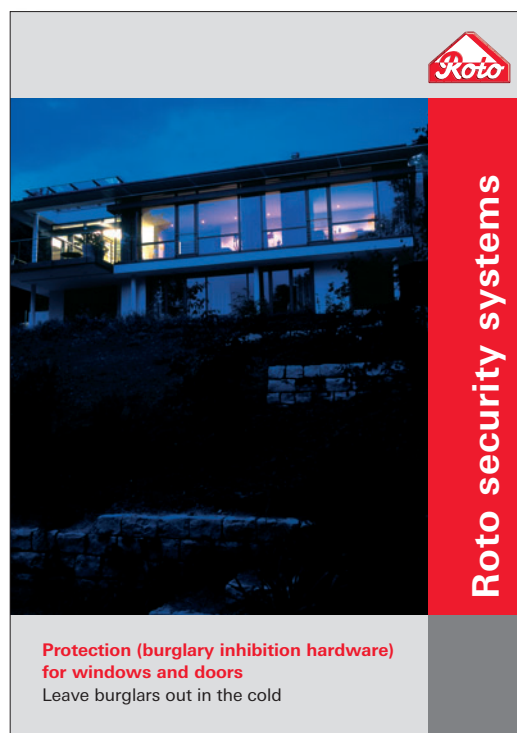

Order no.  
PB 633 GB



Order no.  
BK 8 GB

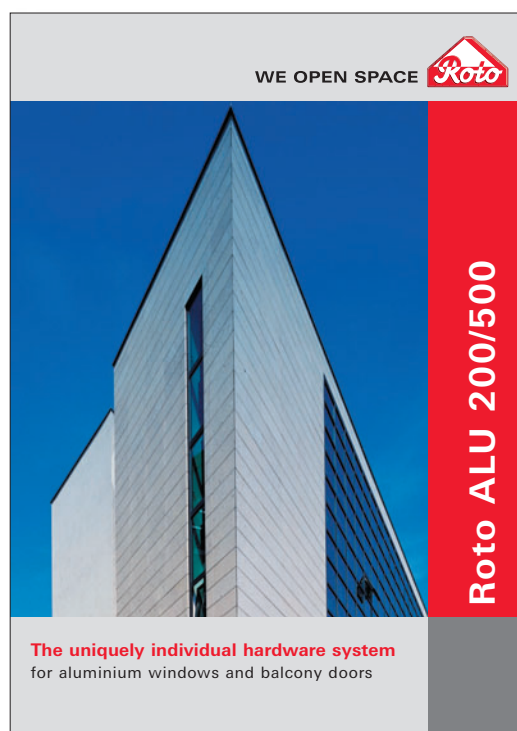

Order no.  
PB 649 GB

# Roto

## The hardware product range



Order no.  
PB 654 GB

Please request the detailed documentation specifying the order number.



Order no.  
PB 659 GB



Order no.  
310550



Order no.  
325135



### Liability exclusion

All specifications in this catalogue were compiled carefully and reviewed. Because of technical progress, whether by means of legislation modification or by lapse of time, the results automatically lead to changes. We therefore hope you shall understand, that we cannot be held liable for the correctness and completeness of the contents. All rights, in particular the right to copy and circulate, reserved.

### Imprint

Copyright: April 2005  
(Translation: Prunty 5/2005)  
Roto Frank AG  
Stuttgarter Strasse 145-149  
D-70771 Leinfelden-Echterdingen, Germany  
Telephone: +49 711 7598-0  
Telefax: +49 711 7598-253  
info@roto-frank.com  
www.roto-frank.com

**Einklappseite mit  
Farbübersicht der Roto Fenstergriffe**

# Roto window handles

## Colour chart



R 01.1 anodised silver, F1



R 01.2 anodised champagne, F2



R 01.3 anodised titanium matt, F9



R 03.1 anodised matt brass, F3



R 04.1 grey-brown, RAL 8019



R 05.3 anodised medium bronze, C33



R 05.5 anodised bronze, F4



R 07.2 traffic-white RAL 9016

**Note:** Colour deviations are possible!

Dated: April 2005. Subject to change.

BK 5-2 GB



# COMPETENCE WITHOUT BOUNDARIES

If further information is required, please contact:

## International subsidiaries:

### Germany

Roto Frank AG  
Velbert factory  
Siemensstrasse 10  
42551 Velbert  
Tel +49 2051 203-1  
Fax +49 2051 203-251

### Belgium

S.A. Roto Frank N.V.  
Rue du Bosquet 1  
Zoning Industriel II  
1400 Nivelles  
Tel +32 67 894140  
Fax +32 67 841456  
E-Mail [info.bel@Roto.be](mailto:info.bel@Roto.be)

### Peoples Republic of China

Beijing Roto Frank Building  
Materials Co., Ltd.  
Xindudongzhan,  
East of Xisanqi, Haidian District  
100096, Beijing  
Tel +86 10 82950045/46  
Fax +86 10 82920115  
E-Mail [info.china@Roto-frank.com](mailto:info.china@Roto-frank.com)

### France

Roto Frank Ferrures S.A.S.  
Zone Industrielle  
1, rue Wilhelm Frank  
57380 Faulquemont  
Tel +33 3 87292440  
Fax +33 3 87292444

### Great Britain

Roto Frank Ltd.  
Swift Point  
Rugby, CV21 1QH  
Tel +44 1788 558600  
Fax +44 1788 558605  
E-Mail [info.uk@Roto-frank.com](mailto:info.uk@Roto-frank.com)

### Netherlands

Roto Frank B.V.  
Dorpsstraat 134  
3991 BZ Houten  
Tel +31 30 6385550  
Fax +31 30 6342840  
E-Mail [info.nl@Roto-frank.com](mailto:info.nl@Roto-frank.com)

### Austria

Roto Frank  
Eisenwarenfabrik AG  
Lapp-Finze-Strasse 21  
8401 Kalsdorf  
Tel +43 3135 504-0  
Fax +43 3135 52727

### Poland

Roto Frank  
Okucia Budowlane Sp z oo  
Wal Miedzeszynski 402  
03-994 Warsaw  
Tel +48 22 87216-00/-04  
Fax +48 22 87216-11  
E-Mail [info.pl@Roto-frank.com](mailto:info.pl@Roto-frank.com)

### Romania

Roto Romania S.r.l.  
Calea 13 Septembrie, Nr. 226  
Bl. V54, Sc. 1, Ap. 10, Sect.5  
7000 Bucharest  
Tel +40 21 2004700  
Fax +40 21 2004701  
E-Mail [info.ro@Roto-frank.com](mailto:info.ro@Roto-frank.com)

### Russia

Roto Frank AG  
Kosmodamianskaja nab. 52,  
Geb. 1  
113054 Moscow  
Tel +7 095 96124-27/-30  
Fax +7 095 96124-31  
E-Mail [info@Roto.ru](mailto:info@Roto.ru)

### Switzerland

Roto Frank AG  
Bernstrasse 390  
8953 Dietikon  
Tel +41 1 7458555  
Fax +41 1 7458556  
E-Mail [info@Roto.ch](mailto:info@Roto.ch)

### Spain

Roto Frank S.A.  
Pol. Industrial Molí de les Planes  
Parcela No. 37  
08470 Sant Celoni (Barcelona)  
Tel +34 93 8675720  
Fax +34 93 8675845  
E-Mail [info.sp@Roto-frank.com](mailto:info.sp@Roto-frank.com)

### Turkey

Roto Frank Ltd. Sti.  
Alemdağ Cad.  
Site Yolu No. 10  
34768 Ümraniye - Istanbul  
Tel +90 216 412-0901  
Fax +90 216 412-0903  
E-Mail [info.tr@Roto-frank.com](mailto:info.tr@Roto-frank.com)

### Hungary

Roto Elzett  
Vasalatkereskedelmi Kft.  
9461 Lövö  
Kossuth u. 25  
Tel +36 99 534-400  
Fax +36 99 367-132  
E-Mail [info.hun@Roto-frank.com](mailto:info.hun@Roto-frank.com)

### USA

Roto Frank of America, Inc.  
Hardware Systems & Roof  
Windows, Research Park  
Chester, CT 06412  
Tel +1 860 526 4996  
Fax +1 860 526 8390  
E-Mail [info.usa@Roto-frank.com](mailto:info.usa@Roto-frank.com)

## International representatives:

### Estonia

Roto Frank Ehitusrautised OÜ  
Peterburi tee 81-512  
11415 Tallinn  
Tel +372 632 6980  
Fax +372 632 6980  
E-Mail [Roto@uninet.ee](mailto:Roto@uninet.ee)

### Greece

Eurotechnica  
Industrial area of Thessalonica A7  
O.T. 18 Nr. 34  
57022 Sindos/P.O. Box 198  
Tel +30 310 796950  
Fax +30 310 796783  
E-Mail [eurotech@eurotechnica.gr](mailto:eurotech@eurotechnica.gr)

### Italy

SARI S.r.l.  
Via delle Industrie 2, no. 8  
30020 Meolo (VE)  
Tel +39 0421 618611  
Fax +39 0421 618455  
E-Mail [info@sarimeolo.com](mailto:info@sarimeolo.com)

### Italy

Tekno System S.r.l.  
Zona Industriale  
SS 89 Km. 9,800  
71011 Apricena (FG)  
Tel +39 0882 647671  
Fax +39 0882 647669  
E-Mail [info@teknoRoto.it](mailto:info@teknoRoto.it)

### Slovenia

Roto Lož d.o.o.  
Cesta 19. oktobra 52  
1386 Stari trg pri Ložu  
Tel +386 1 7095-100  
Fax +386 1 7095-190

### Czech Republic

Roto Nové Město  
Kříčkova ulice 373  
59231 Nové Město na Moravě  
Tel +420 566 652411  
Fax +420 566 652413  
E-Mail [nove.mesto@Roto-nm.cz](mailto:nove.mesto@Roto-nm.cz)

### Ukraine

Roto Frank AG  
wul. Marina Raskowoi, 17-612  
02660 Kyiv  
Tel +380 44 5010418  
Fax +380 44 5685396  
E-Mail [Rotokiev@adamant.net](mailto:Rotokiev@adamant.net)

### Belarus

Roto Frank AG  
Str. R. Luxemburg, 95  
220036 Minsk  
Tel +375 17 2561911  
Fax +375 17 2561912  
E-Mail [Rotominsk@tut.by](mailto:Rotominsk@tut.by)

## Roto Frank AG

Stuttgarter Strasse 145-149 • D-70771 Leinfelden-Echterdingen

Telephone: +49 711 7598-0 • Telefax: +49 711 7598-253

[info@roto-frank.com](mailto:info@roto-frank.com)

[www.roto-frank.com](http://www.roto-frank.com) • [www.infoline-beschlaege.de](http://www.infoline-beschlaege.de)

WE OPEN SPACE





# **Roto handles – The “BK 5 GB” catalogue**

## **Navigational notes**



The contents of this catalogue file are depicted in the form of bookmarks.

In order to reach possible sub topics, click on the plus sign (PC) resp. on the arrow (MAC) beside the bookmark with the desired chapter name.

Once having arrived on the first page of a chapter, you can then leaf through the chapter using the arrows ◀ and ▶ in the navigation window.